

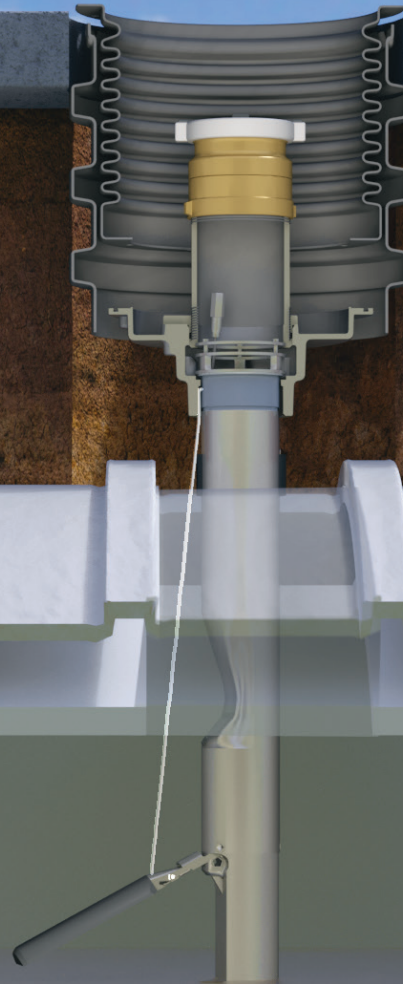

OPW's Testable 71SO-T Overfill Prevention Valve

Testing & Verification
in 3 Easy Steps



Easy, Affordable & EPA Compliant

Are you ready for the EPA's October 13, 2018, compliance deadline? OPW is here to make sure you are.



opwglobal.com

DEFINING | WHAT'S NEXT



Get prepared and protected for overfill prevention equipment inspections with OPW's Testable 71SO-T Overfill Prevention Valve. It's the easiest, quickest and most cost-effective way to ensure that your overfill valves are operational, without having to remove them from the tanks.

- Test each tank from the surface in 60 seconds
- Verify proper installation, orientation and operation without risking damage to the system
- Get compliant with the EPA's new regulations and avoid penalties

TESTING & VERIFICATION EASY AS 1·2·3

The new 71SO-T Testable Overfill Prevention Valve makes testing and verification of proper operation quick and easy. Here's how it works:

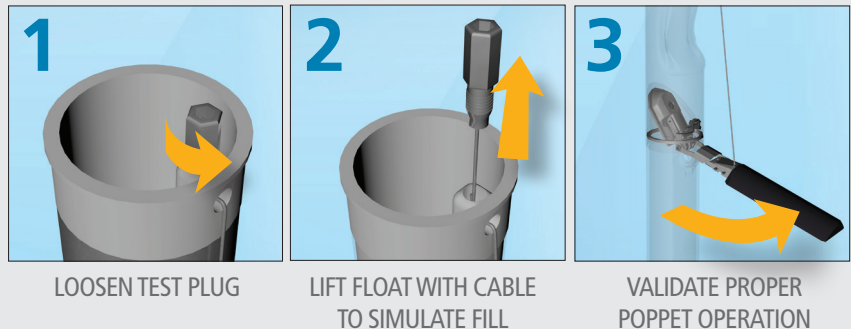

- The Only UST Overfill Prevention Valve that is testable without removal from the tank
- A testable feature is attached to a sealed plug in the inlet adapter
- The plug is easily accessed with a standard socket extension
- Attached to the extension, the testable feature can be raised and lowered, allowing the user to inspect the valve operation from the inside of the tube
- The plug is then easily reinstalled to the inlet adapter from grade
- No fill components, overfill valves, or vapor tight seals have to be removed - avoids compromising vapor tight compliance
- The Testable 71SO-T uses the same industry leading overfill prevention technology for strong vapor tight compliance

71SO-T Ordering Specifications

Product No.	Description	Upper Tube Length		Lower Tube Length		Overall Length		Max. Riser Length		Max. Nominal Tank Diameter		Max. Actual Tank Diameter		Weight	
		in.	m.	in.	m.	in.	m.	in.	m.	in.	m.	in.	m.	lbs.	kg
71SO-400CT	Testable Vapor-Tight Overfill Valve, 5 Ft. Bury, 8 Foot Tank	60	1.5	83	2.1	154-3/4	3.9	53-1/2	1.4	96	2.4	107	2.7	16	7
71SO-410CT	Testable Vapor-Tight Overfill Valve, 10 Ft. Bury, 10 Foot Tank	120	3.1	102	2.6	234-3/4	5.9	113-1/2	2.9	120	3.1	126	3.2	25	11
71SO-420CT	Testable Vapor-Tight Overfill Valve, 10 Ft. Bury, 12 Foot Tank	120	3.1	126	3.2	258-3/4	6.5	113-1/2	2.9	144	3.7	150	3.8	26	12

NOTE: Part Number 71SO-TOOLCT will be needed to install the 71SO-T Overfill Prevention Valve.



3250 US Hwy. 70 Business West ♦ Smithfield, NC 27577 ♦ Customer Service: (800) 422-2525 ♦ Fax: (800) 421-3297

NOTE: All information subject to engineering and/or other changes. All trade names are copyrighted. Patents Pending. ©2018 OPW Fueling Containment Systems. ©2018 Delaware Capital Formation, Inc. All Rights Reserved. DOVER and the DOVER logo are registered trademarks of Delaware Capital Formation, Inc., a wholly-owned subsidiary of Dover Corporation.