

FIBRELITE

FUELING CONTAINMENT SYSTEMS

Fibrelite manufactures a wide range of composite manhole covers, tank and dispenser sump systems and accessories for the retail petroleum industry.

Fibrelite Composite Manholes

Fibrelite offers the retail petroleum industry's leading watertight, easy to remove, non-bolted composite manhole covers in a large selection of shapes and sizes. From general tank sump access to multipoint and single port fill sump applications to interstitial sumps and monitoring wells, Fibrelite has every application covered.

Multiple colors are available – Contact OPW Customer Service for pricing, availability, and lead times.

Materials:

Cover: Fiberglass
Frame: Fiberglass
Skirt: Fiberglass
Cover Includes Frame and Skirt

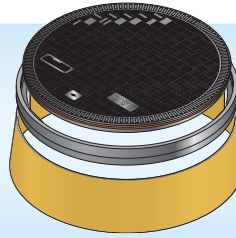

Materials:

Cover: Fiberglass
Frame: Aluminum
Skirt: Fiberglass
Cover Includes Frame and Skirt

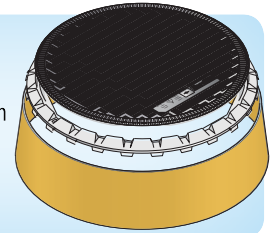

Features & Benefits:

- ◆ UV resistant
- ◆ Round, square and rectangular (wide range of sizes)
- ◆ Anti-slip surface - no costly injury claims
- ◆ Anti-static - fully conductive
- ◆ Will not corrode
- ◆ Watertight, sealed design
- ◆ No bolts required
- ◆ Ergonomic, single person removal and replacement with Fibrelite lifting handle
- ◆ Monolithic structure eliminates delaminating
- ◆ Locks available for all covers
- ◆ Available in any color
- ◆ Heavy Duty covers available for truck stops, bus depots and industrial applications

Ordering Specifications - Complete Cover Assemblies

Complete Grade Level "Flat" Composite Manholes

Part Number	Description	Color	Skirt I. D.	Cover O. D.	Skirt Length	Weight
FL120BLACK-SK12	12" Black Flat Composite Manhole Cover Bonded	Black	12"	15"	12"	26 lbs
FL180BLACK-SK12	18" Black Flat Composite Manhole Cover Bonded	Black	18"	21.2"	12"	40 lbs
FL180GRAY-SK12	18" Gray Flat Composite Manhole Cover Bonded	Gray	18"	21.2"	12"	40 lbs
FL600BLACK-SK12	24" Black Flat Composite Manhole Cover Bonded	Black	24"	27"	12"	76 lbs
FL760BLACK-SK12	30" Black Flat Composite Manhole Cover Bonded	Black	30"	33"	12"	89 lbs
FL90BLACK-SK12	36" Black Flat Composite Manhole Cover Bonded	Black	36"	38.5"	12"	109 lbs
FL90GRAY-SK12	36" Gray Flat Composite Manhole Cover Bonded	Gray	36"	38.5"	12"	109 lbs
FL100BLACK-SK12	40" Black Flat Composite Manhole Cover Bonded	Black	40"	44"	12"	142 lbs
FL100GRAY-SK12	40" Gray Flat Composite Manhole Cover Bonded	Gray	40"	44"	12"	142 lbs

Complete Raised Composite Manholes

FL36BLACK-SK12	36" Black Raised Composite Manhole Cover Bonded	Black	36"	40"	12"	128 lbs
FL42BLACK-SK12	42" Black Raised Composite Manhole Cover Bonded	Black	42"	46.5"	12"	164 lbs
FL42GRAY-SK12	42" Gray Raised Composite Manhole Cover Bonded	Gray	42"	46.5"	12"	164 lbs

Monitoring Well Manholes

FL120BLACK-MW-SK12	12" Black Flat Monitoring Well Manhole Bonded	Black	12"	15"	12"	26 lbs
--------------------	---	-------	-----	-----	-----	--------

Bonded - Assembled Cover, Ring And Skirt • Contact OPW for custom length skirts, heavy duty or colored covers 1-800-422-2525.

Replacement Parts - Replacement Covers

Part Number	Description	Color	Skirt I. D.	Cover O. D.	Cover Height	Weight
FL120BLACK	12" Dia. Black Flat Sealed Composite Cover	Black	12"	15"	3.91"	13 lbs
FL120BLACK-MW	12" Dia. Black Flat Sealed Composite Cover - Labeled Monitoring Well	Black	12"	15"	3.91"	13 lbs
FL180BLACK	18" Dia. Black Flat Sealed Composite Cover	Black	18"	21.2"	3.84"	22 lbs
FL600BLACK	24" Dia. Black Flat Sealed Composite Cover	Black	24"	27"	3.84"	46 lbs
FL760BLACK	30" Dia. Black Flat Sealed Composite Cover	Black	30"	33"	3.84"	59 lbs
FL90BLACK	36" Dia. Black Flat Sealed Composite Cover	Black	36"	38.5"	3.84"	75 lbs
FL100BLACK	40" Dia. Black Flat Sealed Composite Cover	Black	40"	44"	3.84"	110 lbs
FL100GRAY	40" Dia. Gray Flat Sealed Composite Cover	Gray	40"	44"	3.84"	110 lbs
FL36BLACK	36" Dia. Black Raised Composite Cover	Black	36"	40"	3.84"	66 lbs
FL36GRAY	36" Dia. Gray Raised Composite Cover	Gray	36"	40"	3.84"	66 lbs
FL42BLACK	42" Dia. Black Raised Composite Cover	Black	42"	46.5"	3.84"	93 lbs

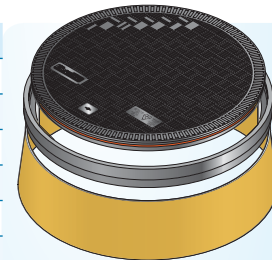

Complete Grade Level "Flat" Composite Manholes

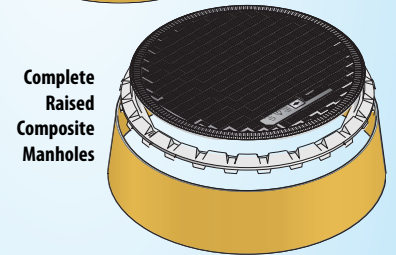

Complete Raised Composite Manholes

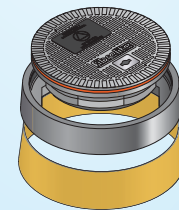

Monitoring Well Manholes

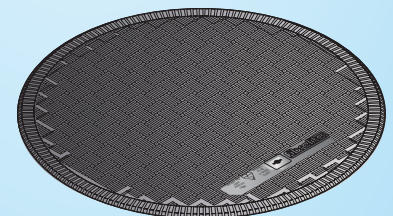

Ordering Specifications

Frames "Mounting Frame"					
Part Number	Description	Skirt I.D.	Manhole Type	Weight (lbs)	
FL120F	12" Composite Frame For FL120 Covers	12"	Flat	7.7	
FL180F	18" Flat Composite Frame For FL180 Covers	18"	Flat	11	
FL600F	24" Flat Composite Frame For FL600 Covers	24"	Flat	17	
FL760F	30" Flat Composite Frame For FL760 Covers	30"	Flat	18	
FL90F	36" Flat Composite Frame For FL90 Covers	36"	Flat	20	
FL100F	40" Composite Frame For FL100 Covers	40"	Flat	26	
FL36F	36" Raised Aluminum Frame For FL36 Covers	36"	Raised	46	
FL42F	42" Raised Aluminum Frame For FL42 Covers	42"	Raised	55	

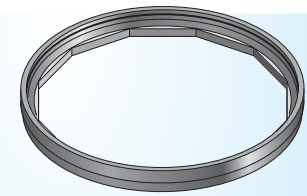

Frames - Flat Fiberglass Mounting Ring

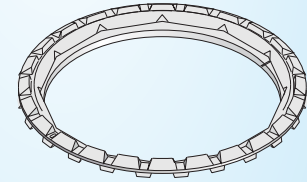

Frames - Raised Aluminum Mounting Ring

Ordering Specifications

Skirts					
Part Number	Description	Skirt I.D.	Manhole Type	Skirt Length	Weight (lbs)
FL120-SK12	12" Deep FRP Skirt To Fit FL120	12"	Flat	12"	5
FL180-SK12	12" Deep FRP Skirt To Fit FL180	18"	Flat	12"	7
FL600-SK12	12" Deep FRP Skirt To Fit FL600	24"	Flat	12"	10
FL760-SK12	12" Deep FRP Skirt To Fit FL760	30"	Flat	12"	12
FL90-SK12	12" Deep FRP Skirt To Fit FL90 Flat	36"	Flat	12"	14
FL100-SK12	12" Deep FRP Skirt To Fit FL100	40"	Flat	12"	16
FL100-SK10-16	10" Deep FRP Skirt To Fit FL100	40"	Flat	10"	15
FL36-SK12	12" Deep FRP Skirt To Fit FL36 Raised Manhole	36"	Raised	12"	15
FL42-SK12	12" Deep FRP Skirt To Fit FL42- Raised Manhole	42"	Raised	12"	16

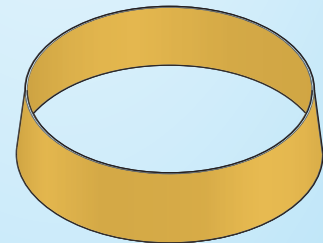

Skirt

Ordering Specifications

Cover Accessories	
Part Number	Description
FL7	Lifting Handle For Raised Covers - FL42/FL36
FL7A	Lifting Handle With Foot Pedal For Watertight Covers - FL100/FL90/FL180
FL7A-ENCL	Enclosure To House FL7A Handles
KEY-HREP-10-76-90	Key Housing Repair Kit & Compound
FIB-KHB	Replacement Rubber Bung
FIB-KHP	Rubber Key Housing Plug
FIB2-RL	Tamper Proof Cover Lock To Fit Watertight Covers - FL100/FL90
FIB2-RL-KEY	Key For FIB2-RL Cover Lock
FL120-SEAL	12" Replacement Gasket For FL120
FL180-SEAL	18" Replacement Gasket For FL180
FL600-SEAL	24" Replacement Gasket For FL600
FL760-SEAL	30" Replacement Gasket For FL760
FL90-SEAL	36" Replacement Gasket For FL90
FL100-SEAL	40" Replacement Gasket For FL100

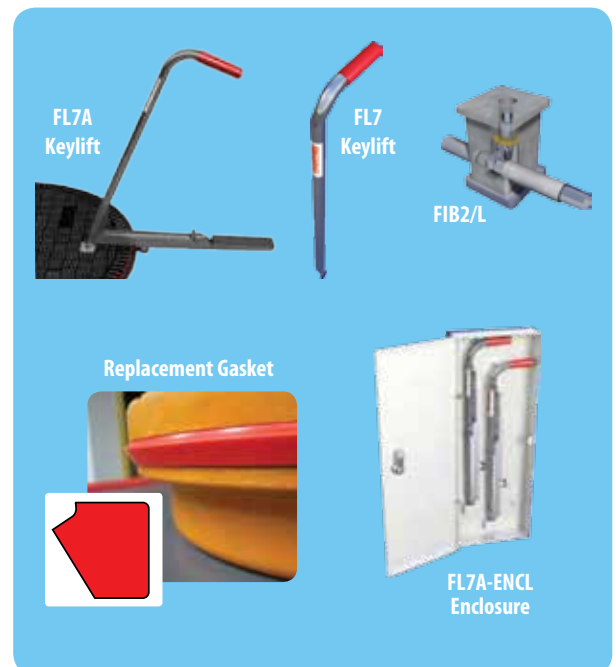

Fibrelite Multi-Port Spill Containment

OPW "Fibrelite" Multi-Port Spill containment manholes provide spill containment for underground storage tank (UST) fill pipes and vapor recovery risers.

Multi-Ports are installed over the top of tank sumps to preserve future access to the tank top and to facilitate containment of tank bung fittings.

Fibrelite's watertight covers are easy to remove composite manhole covers are available with center or offset port for access to fill risers. Spill Containers and water shroud covers are sold separately.

Materials:

Cover: Fiberglass
Frame: Fiberglass
Skirt: Fiberglass

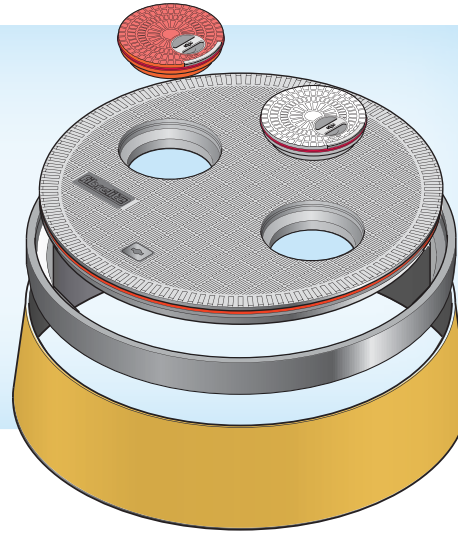

Features & Benefits:

- ◆ **Lightweight - reduce risk of back , foot and hand injuries.**
- ◆ **UV resistant**
- ◆ **Standard duty (20 ton load rating)**
- ◆ **No bolts required**
- ◆ **Anti-slip surface**
- ◆ **Anti-static - fully conductive**
- ◆ **Will not corrode**
- ◆ **Watertight, sealed design**
- ◆ **Ergonomic, single person removal and replacement with Fibrelite lifting handle**
- ◆ **Monolithic structure eliminates delaminating**

Ordering Specifications

Part Number	Description	FRP Cover Color	Skirt I.D.	Cover O.D.	Skirt Length	Riser Spacing	Fill Port Cover	Vapor Cover	Weight (lbs)
FL90GRAY-MP-SK12-G	36" Gray Comp. Dual Multi-port Bonded - All Gray- Multipurpose	Gray	36"	38.5"	12"	16" Centers	Gray	Gray	112
FL90GRAY-MP-SK12-W	36" Gray Dual Multi-port Bonded - Regular Unleaded White	Gray	36"	38.5"	12"	16" Centers	White	Orange	112
FL90GRAY-MP-SK12-BU	36" Gray Comp. Dual Multi-port Bonded - Mid-Grade Blue	Gray	36"	38.5"	12"	16" Centers	Blue	Orange	112
FL90GRAY-MP-SK12-R	36" Gray Comp. Dual Multi-port Bonded - Premium Red	Gray	36"	38.5"	12"	16" Centers	Red	Orange	112
FL90GRAY-OF-SK12-G	36" Gray Comp. Single Port Bonded - All Gray	Gray	36"	38.5"	12"	16" Centers	Gray	Orange	112
FL90GRAY-OF-SK12-Y	36" Gray Single Port Bonded- Yellow Diesel	Gray	36"	38.5"	12"	16" Centers	Yellow	N/A	148
FL100GRAY-MP16-SK12-G	40" Gray Comp. Dual Multi-port Bonded - All Gray- Multipurpose	Gray	40"	44"	12"	16" Centers	Gray	Gray	148
FL100GRAY-MP16-SK12-W	40" Gray Dual Multi-port Bonded - Regular Unleaded White	Gray	40"	44"	12"	16" Centers	White	Orange	148
FL100GRAY-MP16-SK12-R	40" Gray Comp. Dual Multi-port Bonded - Mid-Grade Blue	Gray	40"	44"	12"	16" Centers	Red	Orange	148
FL100GRAY-MP16-SK12-BU	40" Gray Comp. Dual Multi-port Bonded - Premium Red	Gray	40"	44"	12"	8" Offset	Blue	Orange	148
FL100GRAY-OF8-SK12-G	40" Gray Comp. Single Port Bonded - All Gray	Gray	40"	44"	12"	8" Offset	Gray	N/A	148

BONDED - Assembled Cover, Ring and Skirt

Contact OPW for custom Multi-Ports or colored covers.

If you require Black Multiports, substitute BLACK for GRAY in the Part Number.

See Tank Sump page 6 for complete assembly.

Accessories and Replacement Parts

Part Number	Description
P711-EVRDV	5 Gal. Spill Bucket, Composite Base, Drain Valve
P711-EVRPL	5 Gal. Spill Bucket, Composite Base, Plug
P761C-EVRDV	5 Gal. Spill Bucket, Cast Iron Base, Drain Valve
P761C-EVRPL	5 Gal. Spill Bucket, Cast Iron Base, Plug
P511-15-EVRDV	15 Gal. Bucket W/Drain Valve, Composite Base
ID-D	ID Plate-Diesel
ID-M	ID Plate-MidGrade
ID-P	ID Plate-Premium
ID-R	ID Plate-Regular
ID-E85	ID Plate-E85
ID-U	ID Plate-Unleaded
ID-T	ID Plate-Turbine
ID-MW	ID Plate-Monitoring Well
FC-10-BLACK	10" Black Fill Cover
FC-10-BLUE	10" Blue Fill Cover
FC-10-GRAY	10" Gray Fill Cover
FC-10-ORANGE	10" Orange Fill Cover
FC-10-RED	10" Red Fill Cover
FC-10-WHITE	10" White Fill Cover
FC-10-YELLOW	10" Yellow Fill Cover
FC-10-SEAL	Replacement Gasket For FC -10 Covers
FL90GRAY-MP16	36" Gray Replacement Cover 2 Ports, with 16" Centers
FL90GRAY-OF	36" Gray Replacement Cover 1 Port, with 8" Offset
FL100GRAY-MP16	40" Gray Replacement Cover 2 Ports, with 16" Centers
FL100GRAY-OF8	40" Gray Replacement Cover 1 Port, with 8" Offset

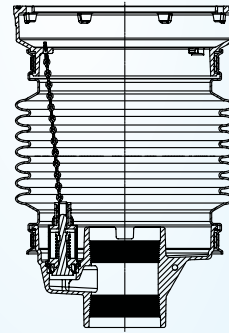

5 Gallon Fill or Vapor Spill Bucket



ID Plate
6" square fiberglass, adhesive backed product ID plates to fit into the cover recess area.

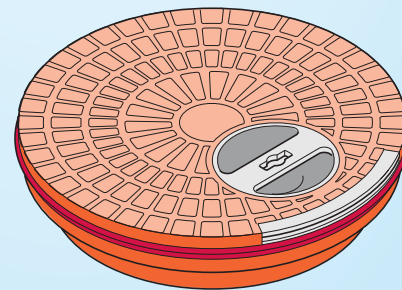

Replacement Fill-Port Covers

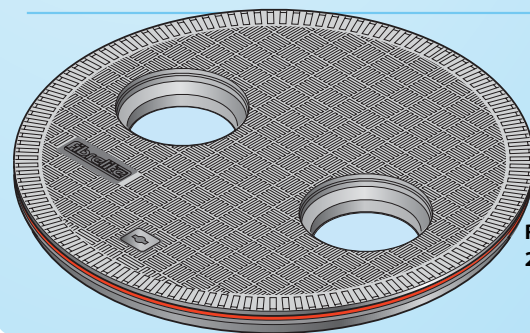

Replacement 2-Port Covers

Fibrelite Tank Sumps

OPW "Fibrelite" Fueling Containment System tank sumps function as a liquid-tight isolation container providing secondary containment for tank fittings valves, pumps and Flexworks or Fiberglass pipe fittings.

They also provide surface access to the tank itself, as well as a clean, dry environment for future service and maintenance. The height-adjustable risers to accommodate different tank bury depths.

Materials:

Sump: Fiberglass

Tank SUMP BASE, TOP HAT, COVER and RESIN KIT must be ordered separately.

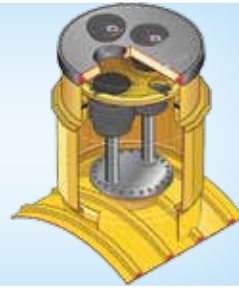

Features & Benefits:

- ◆ **Watertight** – structure will not deform under water pressure
- ◆ Tank Sump bury depths 40" to 60". For depths greater than 60", see extensions on page 7.
- ◆ **Anti-static surface**
- ◆ **Vacuum testable** – during and after installation
- ◆ Available for both new and retrofit applications
- ◆ **Sump extensions available;** extend sump height by 12" per extension
- ◆ Guaranteed uniform 3/8" wall thickness

Ordering Specifications - Tank Sump System Kits

Tank Sump Systems Include: Tank Sump Base, Top Hat with Stainless Steel Retaining Ring, Water Tight Internal Tank Sump Lid, Manhole Cover and Frame, Skirt Bonded to Frame, Polyurethane Sealant

Part Number	Application	Tank Collar	Diameter	Sump			Bonded Manhole	
				Height	Base	WT Cover	Skirt I.D	Color
S8CR-390BL-WT33	45" x 33" Tank Sump with Black MH Cover	42"	45"	33"	Collar Ring	33"	36" FL90	Black
S8CR-390G-WT33	45" X 33" Tank Sump with Gray MH Cover	42"	45"	33"	Collar Ring	33"	36" FL90	Gray
S8CRD-390BL-WT33	45" x 45" Tank Sump with Black MH Cover	42"	45"	45"	Collar Ring	33"	36" FL90	Black
S8CRD-390G-WT33	45" x 45" Tank Sump with Gray MH Cover	42"	45"	45"	Collar Ring	33"	36" FL90	Gray
S8SB-390BL-WT33	45" x 33" Solid Tank Sump with Black MH Cover	N/A	45"	33"	Solid	33"	36" FL90	Black
S8SB-390G-WT33	45" X 33" Solid Tank Sump with Gray MH Cover	N/A	45"	33"	Solid	33"	36" FL90	Gray
S14CR-3100BL-WT33	52" X 33" Tank Sump with Black MH Cover	48"	52"	33"	Collar Ring	33"	40" FL100	Black
S14CR-3100G-WT33	52" X 33" Tank with Gray MH Cover	48"	52"	33"	Collar Ring	33"	40" FL100	Gray
S15CR-3100BL-WT33	60" x 33" Tank Sump with Black MH Cover	54"	52"	33"	Collar Ring	33"	40" FL100	Black
S15CR-3100G-WT33	60" X 33" Tank Sump with Gray MH Cover	54"	52"	33"	Collar Ring	33"	40" FL100	Gray

Resin Kits, and Fiberglass Mounting Kits Are Ordered Separately



Ordering Specifications - Multiport and Offset Fill Sump System Kits

Multiport Systems Include: Tank Sump Base, Top Hat with Stainless Steel Retaining Ring, Water Tight Sump Lid, Multiport Cover and Frame, Skirt Bonded to Frame, Clamping Rings, Fill and Vapor Port Covers

Part Number	Application	Tank Collar	Diameter	Height	Sump		Bonded Manhole		
					Base	WT Cover	Skirt I.D	FRP Cover	Fill & Vapor Covers
S8CR-3100G-MP3716-W	5 Gallon Regular Gasoline Multiport System	42"	45"	33"	Collar Ring	WSP33-16	40"	Gray	White / Orange
S8CR-3100G-MP3716-R	5 Gallon Premium Gasoline Multiport System	42"	45"	33"	Collar Ring	WSP33-16	40"	Gray	Red / Orange
S8CR-3100G-OF378-Y	5 Gallon Diesel Offset Multiport System	42"	45"	33"	Collar Ring	WSP33-8	40"	Gray	Yellow
S14CR-3100G-MP3716-W	5 Gallon Regular Gasoline Multiport System	48"	52"	33"	Collar Ring	WSP33-16	40"	Gray	White / Orange
S14CR-3100G-MP3716-R	5 Gallon Premium Gasoline Multiport System	48"	52"	33"	Collar Ring	WSP33-16	40"	Gray	Red / Orange
S14CR-3100G-OF378-Y	5 Gallon Diesel Offset Multiport System	48"	42"	33"	Collar Ring	WSP33-8	40"	Gray	Yellow
S15CR-3100G-MP3755-W	15 Gallon Regular Gasoline Multiport System	54"	60"	33"	Collar Ring	WSP33-16	40"	Gray	White / Orange
S14CR-3100G-MP37555-R	15 Gallon Premium Gasoline Multiport System	54"	60"	33"	Collar Ring	WSP33-16	40"	Gray	Red / Orange
S14CR-3100G-OF3727-Y	15 Gallon Diesel Offset Multiport System	54"	60"	33"	Collar Ring	WSP33-16	40"	Gray	Yellow

Spill Containers, Resin Kits, and Fiberglass Mounting Kits Are Ordered Separately





Ordering Specifications - Sump Base

Part Number	Application	Diameter	Height	Base	Weight (lbs)
S45	18" Dia. X 18" Deep FRP Solid Base Sump	18"	18"	Solid	33
S8SB	45" Dia. X 24" Deep FRP Sump W/ Solid Structural Base	45"	24"	Solid	90
S8SBD	45" Dia. X 33" Deep FRP Sump W/Solid Structural Base	45"	33"	Solid	98
S8CR	45" Dia. X 33" Deep FRP Sump W/ 42" Collar Ring Attachment	45"	33"	Collar Ring	68
S8CRD	45" Dia. X 45" Deep FRP Sump W/ 42" Collar Ring Attachment	45"	45"	Collar Ring	45
S14CR	52" Dia. X 33" Deep FRP Sump W/48" Collar Ring Attachment	52"	33"	Collar Ring	75
S15CR	57" Dia. X 36" Deep FRP Sump W/54" Collar Ring Attachment	57"	36"	Collar Ring	100

Tank SUMP BASE, TOP HAT, COVER and RESIN KIT must be ordered separately.

Ordering Specifications - Top-Hat

Part Number	Application	Diameter	Reducer Opening	Weight (lbs)
S42-3100-TH	42" Dia. Round Sump - 37" Dia. Reducer Opening Other FRP Sumps	42"	37"	36
S8-390-TH	S8 Sump system includes retaining ring	45"	33"	35
S8-3100-TH	S8 Sump system includes retaining ring	45"	37"	37
S14-390-TH	S14 Sump system includes retaining ring	52"	33"	40
S14-3100-TH	S14 Sump system includes retaining ring	52"	37"	49
S15-390-TH	S15 Sump system includes retaining ring	57"	33"	50
S15-3100-TH	S15 Sump system includes retaining ring	57"	37"	52

Ordering Specifications

Optional Extensions for Deep Bury



Part Number	Application	Diameter	Reducer Opening	Weight (lbs)
S8-EX12	12" Deep Yellow FRP Extension For S8 Sump	45"	12"	18
S14-EX12	12" Deep Yellow FRP Extension For S14 Sump	52"	12"	21
S15-EX12	12" Deep Yellow FRP Extension For S15 Sump	57"	12"	23

Ordering Specifications

Turbine Sump Watertight Cover Lids

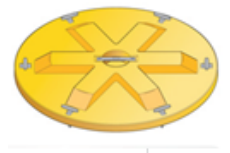

Part Number	Application	Diameter	Weight (lbs)
WT-31	31" Dia. Watertight, Structural Spill Platform	31"	11
WT-33	33" Dia. Watertight, Structural Spill Platform	33"	13
WT-37	37" Dia. Watertight, Structural Spill Platform	37"	17

Ordering Specifications - Multi-Port Watertight Spill Platform

Part Number	Application	Diameter	Height	Base	Weight (lbs)
WSP33-16	Dual Access Ports 16" Centers - Slope to Fill bucket	33"	(2) 5 Gallon	16" Center	13
WSP33-8	Single Access Port At 8" Off Center Slope to Fill bucket	33"	(1) 5 Gallon	8" Offset	13
WSP37-16	Dual Access Ports At 16" Center - Slope to Fill bucket	37"	(2) 5 Gallon	16" Center	17
WSP37-8	Single Access Port At 8" Off Center. Slope to Fill bucket	37"	(1) 5 Gallon	8" Offset	17
WTS37-16	Dual Access Ports At 16" Center - No Slope to Fill bucket	37"	(2) 5 Gallon	16" Center	17
WTS37-8	37" Dia Single Access Port At 8" Center No Slope to Fill bucket	37"	(1) 5 Gallon	8" Offset	17
WSP37-550	Dual Access Ports At 21.5" Center. Slope To Fill Bucket	37"	(2) 15 Gallon	21.5" Center	17
WSP37-275	Single Access Port At 11" Off Center. Slope To Fill Bucket	37"	(1) 15 Gallon	11" Offset	17

All Multi-Port Platforms include WSP/CRK bucket clamping Kits

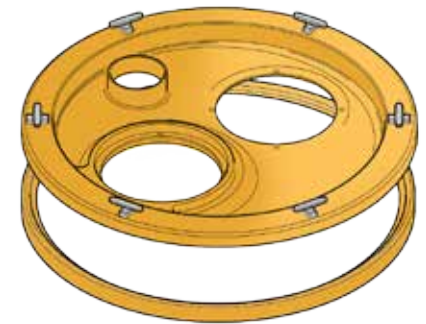

Ordering Specifications - Brine Monitoring Reservoir

Part Number	Application	Weight (lbs)
S45-1180BL	18" DIA. x 18" DP FRP SUMP w/ FL180F & FL180BLACK COVER	76
S45-1180G	18" DIA. x 18" DP FRP SUMP w/ FL180F & FL180GRAY COVER	76



Ordering Specifications - Sump Accessories

Part Number	Application
40FC-GRAY	Gray Polyurethane Sealant
40FC-YELLOW	Yellow Polyurethane Sealant
S-CS-SEALANT	2 Part Self Leveling Sealant - Used To Seal Gap Between The & Skirt
S-CR-FGK	Kit For Bonding Collar Ring To Tank Collar - Includes Resin, Catalyst & Glass Tape.
RK-5000	Epoxy Resin Kit Bonding Collar Ring Sump To Fiberglass Tank Collar
PLEX-TUBE	1 Tube Of Plexus Adhesive
PlexisApplicator	Single Barrel Manual Applicator
S-HANGERS	Adjustable Height Hanger Kit For Skirt Installation On Tank Sumps
WSP-CRK	2 Part Clamping Ring Kit To Clamp P711 Spill Bucket To Internal Watertight Lid

Contact OPW for Tank Fittings and Manway Adaptors - 1-800-422-2525

Ordering Specifications - Sump Accessories

Part Number	Application
WSP-WTS-OPC	6" Nitrile Observation Port Cap For WSP
WTS-CAP-14	14" Nitrile Container Port Cap For WSP
WS-RING-31	31" Stainless Steel Retaining Ring For Top Hat
WS-RING-33	33" Stainless Steel Retaining Ring For Top Hat
WS-RING-37	37" Stainless Steel Retaining Ring For Top Hat
S-TH-RISER-31	10" Deep Top Hat Riser For All 31" Dia. Opening
S-TH-RISER-33	10" Deep Top Hat Riser For All 33" Dia. Opening
S-TH-RISER-37	10" Deep Top Hat Riser For All 37" Dia. Opening



1 OPW Corporate Headquarters

9393 Princeton-Glendale Road
Hamilton, Ohio, USA 45011
Tel: (800)-422-2525
Fax: (800)-421-3297
Int'l Tel: (513) 870-3315
Int'l Fax: (513) 870-3157
domesticsales@opw-fc.com
www.opwglobal.com

2 OPW Fuel Management Systems

6900 Santa Fe Dr.
Hodgkins, Illinois, USA 60525
Tel: 708 485-4200
Fax: 708 485-7137
info@opwfms.com
www.opwglobal.com

3 OPW RETAIL FUELING

3250 US Highway 70 Business West
Smithfield, NC 27577-6954
Telephone: (919) 934-2786
Fax: (919) 573-9497
Customer Service: 1(800) 422-2525
Customer Service Fax: 1(800) 421-3297
www.opwglobal.com

4 OPW Latin America

6 Poland/Petro Vend of Poland, Inc.

8 OPW EMEA Czech Republic

10 OPW Asia Pacific

5 OPW Mexico

7 OPW EMEA Headquarters

9 OPW India

11 OPW Russia

OPW Retail Fueling

Components and products to protect the environment and the consumer at retail fueling sites for conventional and alternative fuels.

OPW Electronic Systems

Innovative electronic tank gauges and fuel control systems to ensure customers know how much fuel they have and where it is going.

OPW Chemical & Industrial

Safe and efficient loading and unloading of critical hazardous chemicals: loading arms, swivel joints, sight flow indicators, quick and dry disconnect couplers, and safety breakaways.

OPW Transportation

Components and systems for use on Tank Trucks and Rail Tank Cars to ensure the safe handling, loading, transport and unloading of hazardous bulk products, including: petroleum, chemical and dry bulk cargo.