

NEW WATER-TIGHT MULTI-PORT SYSTEM

Water Intrusion Exclusion

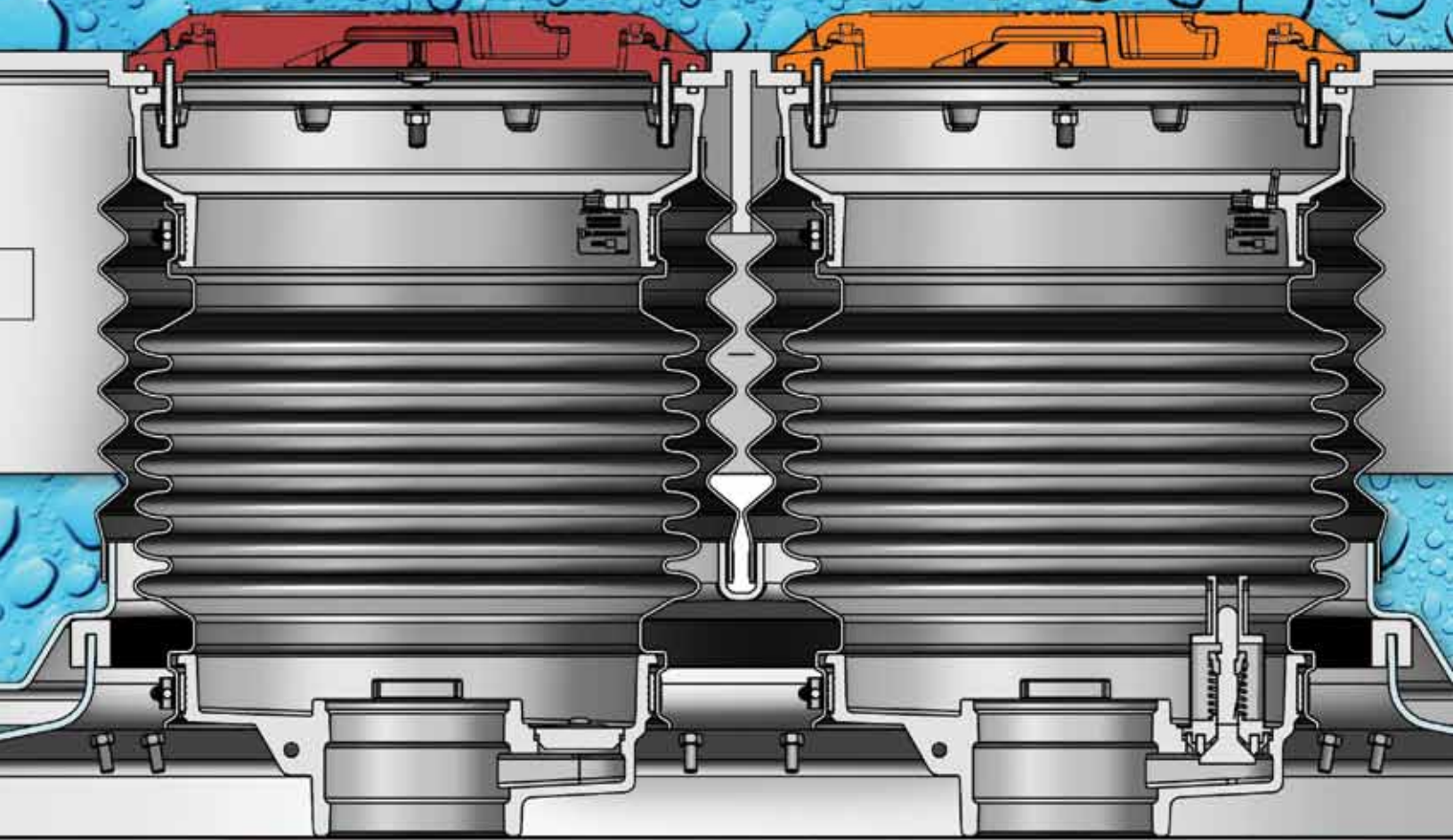

FEATURES AND BENEFITS

- ◆ Allows water-tight access to both spill buckets and containment sump
- ◆ Contractor friendly – allows easy inspection of sump and spill buckets from grade
- ◆ CARB Certified
- ◆ Bolt down design allows even compression to facilitate water-tight sump access
- ◆ New state-of-the-art dual observation ports for added protection, inspection and maintenance

OPW ◆

A DOVER™ COMPANY



Compression Seal

Positive Seal Arrangement
Prevents Water
from Entering Sump



Machined Groove

Provides Consistent Factory
Sealing Surfaces to
Prevent Ground Water Ingress

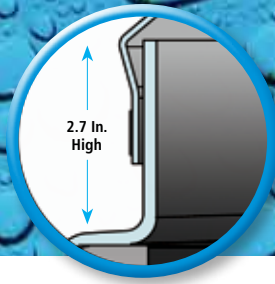

Water Shroud Cuff

Increased Sealing Surface
for Maximum Protection



Bolt-Down Shroud

Maximum Mechanical
Stability for Robust
Water-Tight Protection

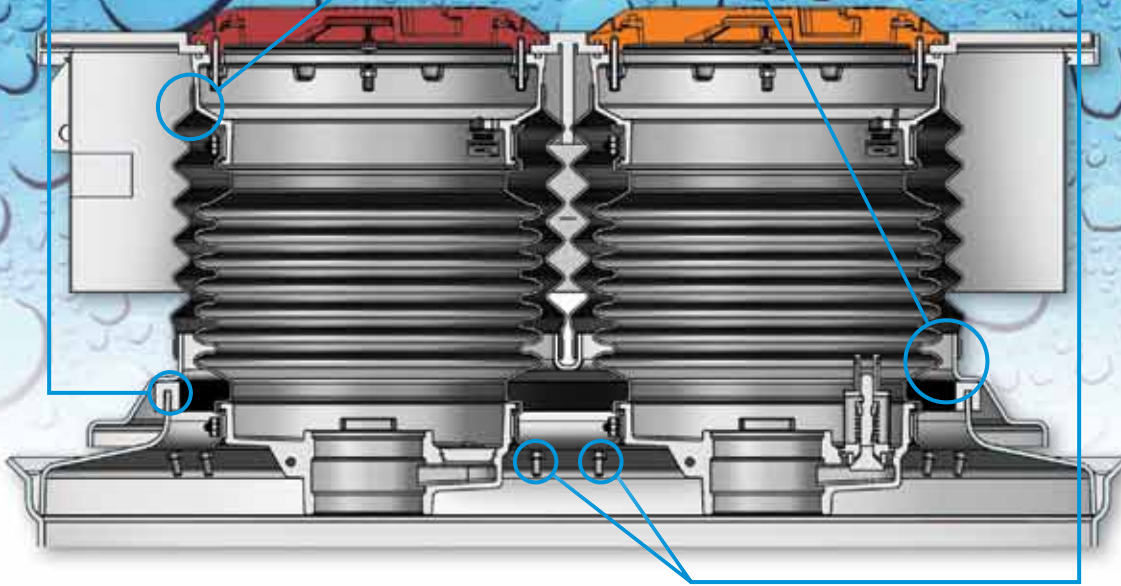

The OPW Multi-Port Manhole with the new bolt-down, water-tight Water Shroud System

is designed to completely isolate water and condensation from the tank sump. This new system features an injection molded fiberglass Water Shroud lid that mates to a standard tank sump top hat reducer. The new bolt down design allows even compression to facilitate water-tight sump access.

Shroud Boots isolate the spill container buckets using stainless steel band clamps, which provide a tight seal between the water shroud top hat and the underside of the spill container mounting rings. 6" Sump Inspection Ports are provided on each FRP Cover, allowing full inspection access through the Multi-Port Gauge Port.

Ordering Specifications

Part #	Description
Bolt-Down Water Shroud Options	
MPWS-33BD	33" FRP Bolt-Down Water Shroud / Includes 203246 42" x 33" FRP Bolt-Down Top Hat / Dual Port
MPWS-39BD	39" FRP Bolt-Down Water Shroud / Includes 203272 42" x 39" FRP Bolt-Down Top Hat / Quad Port
Bolt-Down FRP Top Hat Options	
203246	42" x 33" FRP Bolt-Down Top Hat
203272	42" x 39" FRP Bolt-Down Top Hat

Replacement Parts

Part #	Description
C05223M	Shroud Boot Cap to Isolate One FRP Cover Port
D02575M	5 Gallon Shroud Boot
SIP-6	6" Sump Inspection Port Sight Glass
SIP-4	4" Sump Inspection Port Sight Glass for Quad Port
205181	Lower Clamp for 5 Gallon Shroud
205183	Upper Clamp for 5 Gallon Shroud

- ◆ **Contractor-Friendly Installation** – studded mounting ring simply bolts together inside the spill containment bucket. No need to align bolt holes in the manhole cover.
- ◆ **Raintight Service** – nitrile gaskets on the manhole and spill bucket mounting rings help prevent contamination of the sump area from surface water intrusion.
- ◆ **Highway 20 Load Rating** – the rugged diamond plate steel manhole covers, as well as the ductile iron (RT) or aluminum (SC) spill container covers meet H20 Load Rating requirements.
- ◆ **Spill Container and Manhole Positive I.D. System** – special recesses cast into spill container covers allow product I.D. tags to be attached to the lids. Matching bucket tags can be affixed to the inside of the spill container to prevent covers from getting switched.
- ◆ **CARB Certified** – 500 Series CARB EVR Approved Executive Order #VR-102
- ◆ **Fill/Vapor Ports** – configurations are available to accommodate a single fill riser, dual ports for both a fill and vapor riser, and triple and quad ports for multiple fill and vapor risers. Ports can be supplied with or without containment buckets.
- ◆ **Port Configurations** – standard port locations match the popular riser spacings (16" or 24") and bung configurations on underground storage tanks. Custom port locations are easily accommodated. For riser spacings less than 16", old style buckets must be used.
- ◆ **Manhole Cover Sizes** – standard bolt-down manhole cover diameters of 30" (76 cm), 37" (94 cm), 42" (107 cm) and 48" (122 cm) allow ample access to the sump area. Heavy-duty reinforced lid options are also available upon request.
- ◆ **Spill Container Cover Options** – standard spill container options include the patented POMECO/OPW dam and groove raintight (RT) design and the watertight Sealable Cover (SC) "plumber's plug" design. The raintight cover features a finger-grip lifting facility and an integral seal. The sealable cover features a cam-operated mechanism that expands the seal against the vertical wall of the mounting ring. Both of these water-shedding covers are protected by raised mounting rings.
- ◆ **Fastener Options** – two types of fasteners are available to secure the manhole lid and monitoring port to mounting rings. Standard are 5/16"-18 hex head bolts. Optional are POMECO/OPW Roto-Lock Fasteners. The POMECO/OPW Roto-Lock system enables a secure, watertight connection without the need to locate threaded bolt holes on the mounting ring.
- ◆ **Custom Multi-Port Manholes** – contact your POMECO/OPW representative.
- ◆ **Powder Coated Rings & Covers** – available upon request.
- ◆ **Replacement Covers** – see POMECO Part Number Configurations at www.opwglobal.com.

Multi-Port Manhole Water Shroud System Option*

The OPW/POMECO Multi-Port Manhole Water Shroud (MPWS) system is designed to completely isolate surface water. The MPWS features an injection-molded fiberglass Water Shroud lid that mates to a standard tank sump top hat reducer. Shroud Boots isolate the spill container buckets using stainless steel band clamps, which provide a tight seal between the water shroud top hat and the underside of the spill container mounting rings. A 6" Sump Inspection Port is provided on each FRP Cover, allowing full inspection access through the Multi-Port Gauge Port. The OPW/POMECO Water Shroud system is available in 33" and 36" models. The MPWS Water Shroud is sold separately.

* Only available for use with post 11/03 design "EVR" spill containers.

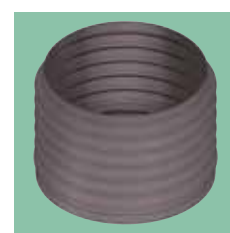

Shroud Boots – Vinyl Plastisol



Sump Inspection Port (SIP) – Clear ABS Construction Inspection Port



FRP Cover – Injection Molded Fiberglass Cover

POMECEO/OPW MULTI-PORT SPILL CONTAINMENT ORDERING SPECIFICATIONS

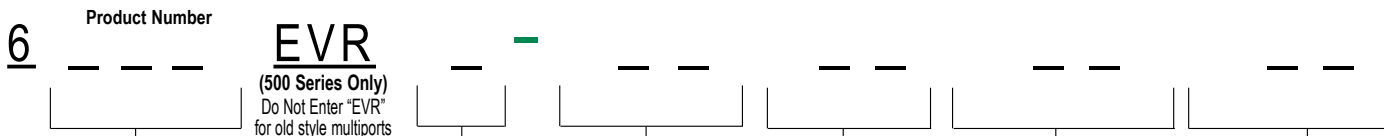

Bolt Down Model Number

- 511EVR - HDPE Bellows, Thread-On Composite Base, Bolt-Down
- 561EVR - HDPE Bellows, Thread-On Cast Iron Base, Bolt-Down
- 411- HDPE Bellows, Slip-On Composite Base

Roto-Lock Model Number

- 521EVR - HDPE Bellows, Thread-On Composite Base, Roto-Lock
- 571EVR - HDPE Bellows, Thread-On Cast Iron Base, Roto-Lock
- 421- HDPE Bellows, Slip-On Composite Base with Roto-Lock Fasteners

Optional Roto-Lock Fastener System

The POMECEO/OPW Roto-Lock system enables a secure raintight connection without the need to locate threaded bolt holes on the mounting ring.

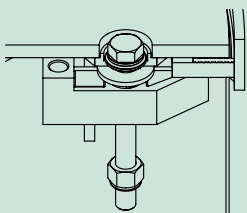

Fill/Vapor Port Configurations

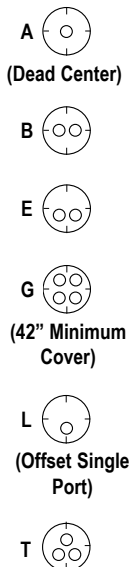

Note: 43 or 49 style Gauge Port must be used if a water shroud is to be used with L style

Replacement / Retrofit Manhole

RP* - (No Ring / Skirt)

*RP cover orders must be accompanied by an up-to-date POMECEO field survey form.

Riser Spacing

- 00 - Single Port (A Configurations)
- 16 - 16" Centers
- 24 - 24" Centers (42" Minimum Cover)



Riser Spacing

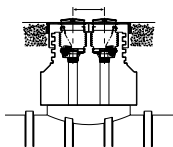

Gauge Port Location

- 00 - No Gauge Port
- 40 - Port at 12 o'clock
- 43 - Port at 3 o'clock
- 46 - Port at 6 o'clock
- 49 - Port at 9 o'clock
- 4M - Port in Center

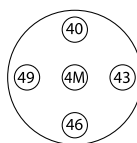

Port Location Example

NOTE: 3M Style gauge port must be used with port in the center of "G" Style

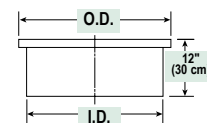
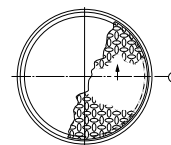

Manhole Cover Size*

- 30" (Configurations)
- 36 - 36" Retrofit Only
- 37 - 37"
- 39 - 39" Retrofit Only
- 42 - 42"
- 48 - 48"
- * 42 is standard

Dimensions

O.D.		I.D.		Thickness	
in.	cm	in.	cm	in.	cm
30	76	26 ⁵ / ₈	68	3/8	0.952
37	94	34 ⁵ / ₈	88	3/8	0.952
42	107	39 ⁵ / ₈	101	1/2	1.27
48"	122	44 ⁵ / ₈	113	1/2	1.27

EVR Multi-Ports

Thread-On Spill Containers are available in composite or cast iron bases with either 5 or 15-gallon buckets. (1) Drain Valve Spill Bucket & (1) Plug Spill Bucket standard on Dual Ports. Drain Valve Spill Bucket standard on Single Port.

Optional ACCESSORIES

Part #	Description
6511ROS-4X2	Offset Vapor Riser 4" Threaded, 2" Offset
6511-RB16	12" to 18" Riser Spacer
6511-RB24	20" to 26" Riser Spacer
H15144M	4" NPT Nipple, 4" Length
H12806M	4" NPT Nipple, 5" Length
VPN4X7	4" NPT Nipple, 7" Length
VPN4X9	4" NPT Nipple, 9" Length
H15271M	4" NPT Nipple, 8" Length
H15268M	4" NPT Nipple, 10" Length
TC-400	4" Torque Cap for 4" Nipples
6521-XAR37	36", 37" OR 38" Roto-Lock Adaptor Ring to convert from Bolt Down
6521-XAR42	39" OR 42" Roto-Lock Adaptor to convert from Bolt Down
6521-XAR48	48" OR 52" Roto-Lock Adaptor to convert from Bolt Down

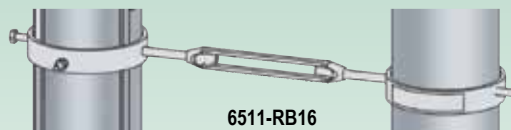

6511-RB16 Riser Spacer



Offset Adaptor



Torque Cap

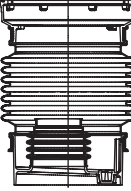
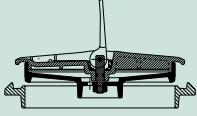
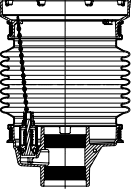

4" Nipple

Spill Container Cover Style**	Spill Container Capacity***	# Of Ports With Containment	Powder Coated Manhole Cover
RT - Raintight	00 - No Containment	0	P
SC - Sealable Cover	05 - 5-Gallon	1	
00 - No Ring or Cover	15 - 15-Gallon	2	
	*** 5-Gallon bucket is standard	3	
RT - Raintight		4	
	411-5-gallon (Slip-On)		
SC - Sealable Cover (Lid in open position)			
** Raintight cover is standard	511-5-gallon (Thread-On)		

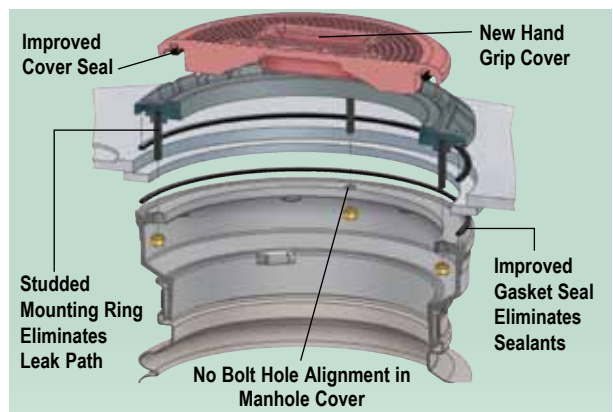

Current Replacement Parts

For New 500 Series EVR Multi-Ports 6511/6521, 6561/571 made post 11/2003

Part #	Description
P711-EVRDV	Replacement 5-Gallon Bucket, w/ Drain Valve
P711-EVRPL	Replacement 5-Gallon Bucket, w/Plug (Vapor)
P761C-EVRDV	Replacement 5-Gallon Bucket, C.I. Base w/Drain Valve
P761C-EVRPL	Replacement 5-Gallon Bucket, C.I.
P411-EVRPL	Replacement 5-Gallon Slip-On Bucket
P511-15-EVRDV	Replacement 15-Gallon Bucket, Comp Base, W/ Drain Valve
C05170M	Gasket, Spill Bucket & Mounting Ring
H15187M	Replacement Seal for New Rain Tight Cover

Note: New P711 & P761 EVR buckets will only work with New "EVR" Multi-Port covers. (made post 11/2003)

See page 91 for replacement rings and covers part numbers.

Old Style Replacement Parts	
311/411/511/521 Series Multi-Ports	
Note: 511/521 parts are for Multi-Ports made prior to Nov. 2003	
Part #	Description
1DK-2100-EVR	511/521 Series Drain Valve
P511SC-RING	Mounting Ring for SC Cover
H13931M	Replacement Seal for SC Cover
P110-37G	34"- 37" Manhole Gasket
P110-42G	42" Manhole Gasket
P110-48G	48" Manhole Gasket
PROTO-LOCK	(1) Roto-Lock
P40-ROTOLID	Replacement 40 Style Gauge Port Roto-Lock Lid
H15240M	Replacement Gasket for 40 Style Gauge Port
P511-BK	Steel Cover Bolt & Gasket Kit, (4 each) for complete cover
P-30L	Replacement 30 Style Bolt Down Gauge Port Lid
P311-G	Bucket Top Flange Gasket
P511-SCBK	Spill Bucket SC Ring Kit (4) Bolts, Washers & Gaskets
P511BUCKETBOLT	Spill Bucket RT Ring Kit (4) Bolts, Washers & Gaskets
H15238M	Replacement Gasket, 30 Style (Bolt Down)

Part #	Description
411 Parts	P2105BUCKET 411 Replacement Bucket 5-Gallon
	1P-2105 Hand Pump Kit for 411/P2105
	P111-WTL Replacement Cover (RT)
	P111WTL-S Replacement Seal for RT Cover
	P311-1R Replacement RT Ring
	P311-14 RT Ring for 14" Riser
	P511YBUCKET Replacement Waste Oil Bucket
	P511-DEVRBUCKET Replacement 5-Gallon Bucket with Drain Valve
	P511-G14 Bucket Top Flange Gasket for Notched Gasket Set
	P511-PEVRBUCKET Replacement 5-Gallon Bucket with Plug
	P511C-DEVRBUCKET Replacement 5-Gallon Bucket With C.I. Base and Drain Valve
511/521 Parts	P511C-PEVRBUCKET Replacement 5-Gallon Bucket With C.I. Base and Plug
	P511-DEVRB-14 Replacement 5-Gallon Bucket with Drain Valve 12" & 14" Risers
	P511-PEVRB-14 Replacement 5-Gallon Bucket with Plug - 12" & 14" Risers
	P511C-DEVRB-14 Replacement 5-Gallon Bucket W/ C.I. Base, Drain Valve for 12" & 14" Risers
	P511C-PEVRB-14 Replacement 5-Gallon Bucket W/ C.I. Base, Plug, for 12" & 14" Risers
	P521-GKIT 521 Multi-Port Complete Gasket Kit
	P511-GKIT 511 Multi-Port Complete Gasket Kit

Multi-Port Manhole Water Shroud System Option

The new OPW/POMECO Multi-Port Manhole Water Shroud System (MPWS) is designed to completely isolate surface water and condensation from the tank sump. The MPWS features an injection-molded fiberglass Water Shroud lid that mates to a standard tank sump top hat reducer. Shroud Boots isolate the spill container buckets using stainless steel band clamps, which provide a tight seal between the water shroud top hat and the underside of the spill container mounting rings. A 6" Sump Inspection Port is provided on each FRP Cover, allowing full inspection access through the Multi-Port Gauge Port. The OPW/POMECO Water Shroud system is available in 33" and 36" models. The MPWS Water Shroud is sold separately.

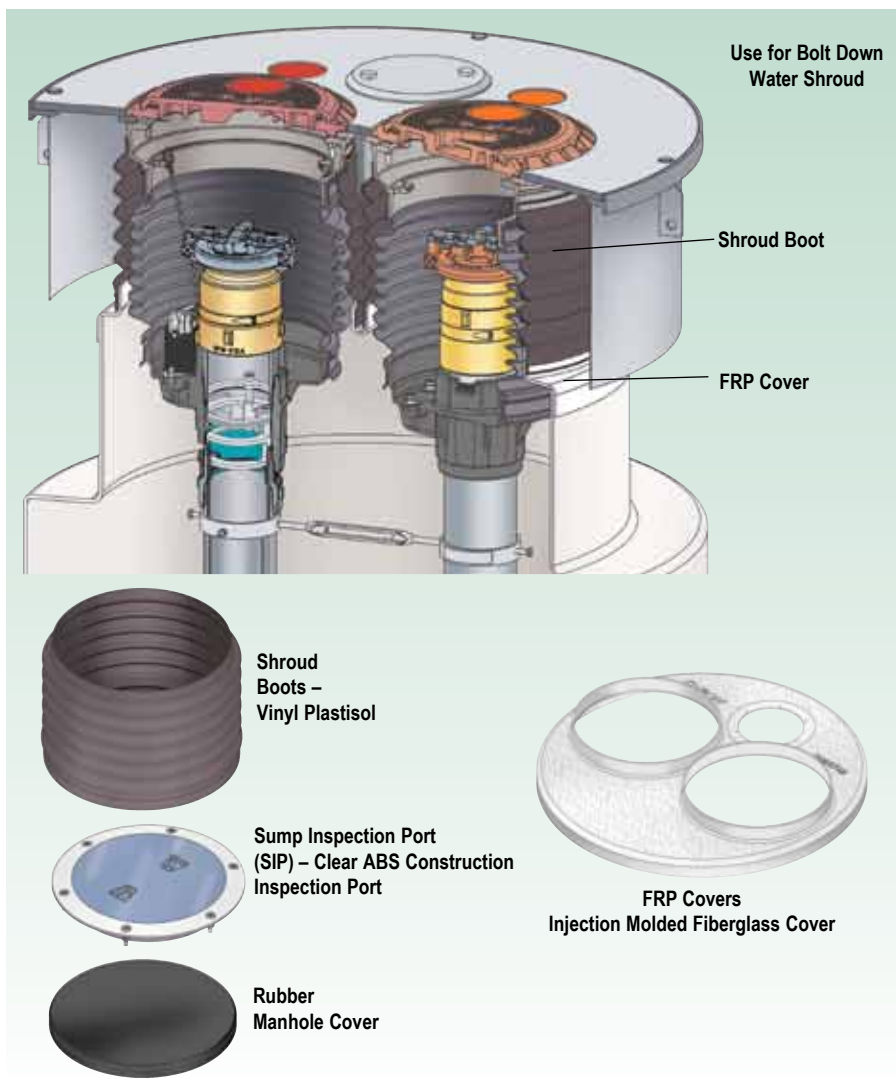

Ordering Specifications

Part #	Description
MPWS-33	33" FRP Cover with (2) 5-gallon Water Shroud Boots & Clamps
MPWS-33BD	33" Bolt Down Water Shroud
MPWS-36	36" FRP Cover with (2) 5-gallon Water Shroud Boots & Clamps
MPWS-39BD	39" Bolt Down Water Shroud
MPWS-43	43" FRP Port Cover with (1) 15 and (1) 5-gallon Water Shroud Boots & Clamps

Replacement Parts	Description
C05223M	Shroud Boot Cap to Isolate One FRP Cover Port
D02571M	33" FRP Replacement Cover
D02586M	36" FRP Replacement Cover
D02575M	5-gallon Shroud Boot
D02701M	43" Replacement Cover
D02702M	15-gallon Shroud Boot
H15188M	Lower Clamp for 5-gallon Shroud Boot
H15190M	Upper Clamp for 5 or 15-gallon Shroud Boot
H15292M	Lower Clamp 15-gallon
SIP-6	6" Sump Inspection Port Sight Glass
SLPK	Gasket and Sealant Kit for Shroud