

Special Application Sumps & Extensions

FlexWorks Special Application Sumps are installed below-grade and provide a convenient means of housing a multitude of underground piping connections and equipment, including valves, filters, meters and pumps. The PSL-3830 Line Connection Sump has large horizontal flats to accommodate multiple piping entries. The PSL-3630 Tall Mini-Sump has long vertical flats to accommodate applications with varying pipe entry heights. The PSL-2430 Mini-Sump is ideal for connecting long pipe runs in a contained area.

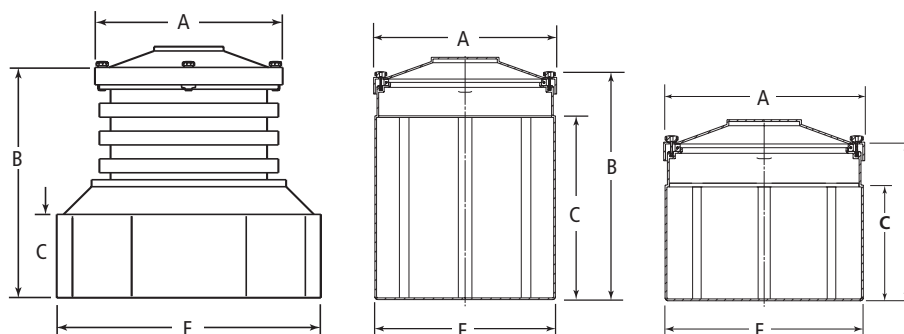

Ordering Specifications - Polyethylene Tank Sumps (with Compression Fit Covers)

| Model # | Application | Dimensions | | | | | | | | | | Burial Depth | | | | Weight | | |
|----------|-------------------------------------|-------------|-----|---------|-----|----------|-------|---------------|-----------|-------------|--------|--------------|------|------|------|--------|------|----|
| | | Manway Dia. | | A Cover | | B Height | | Dimesions CXE | | # of Panels | E Base | | max. | | min. | | lbs. | kg |
| | | in. | mm | in. | mm | in. | mm | in. | mm | | in. | mm | in. | mm | in. | mm | | |
| PSL-2430 | Special Application Sump, 24" x 30" | 30 | 762 | 27 | 686 | 24 | 610 | 16 x 10 | 406 x 254 | 8 | 26 | 660 | 36 | 914 | 26 | 660 | 36 | 16 |
| PSL-3830 | In-Line Sump, 38" x 30" | 30 | 762 | 27 | 686 | 63 | 1,600 | 12 x 38 | 305 x 965 | 12 | 38 | 965 | 41 | 1041 | 29 | 737 | 85 | 38 |
| PSL-3630 | Special Application Sump, 36" x 30" | 30 | 762 | 27 | 686 | 36 | 914 | 28 x 20 | 711 x 508 | 8 | 26 | 660 | 48 | 1219 | 40 | 1016 | 42 | 19 |

Replacement Parts

| Part # | Description |
|---------|----------------|
| D02095M | 27" Poly Cover |
| H13426M | 27" Seal |
| H13257M | Knob (each) |