

M2054-QS LX4 Quick-Start

To download the M2050-EU LX4 Installation Manual from the OPW-FMS website, go to:
https://www.opwglobal.com/docs/libraries/opw-fms/manuals/opw-fms-manuals/m2050-eu-lx4-installation-manual.pdf?sfvrsn=573354c7_4

Connect to the LX Console

This section shows how to connect directly to the console with a standard RJ45 cable.



NOTE: If you have a connection problem with a standard RJ45, as an option, try an **RJ45 Crossover cable**.

Connect an RJ45 cable from your laptop Ethernet port to the Ethernet port on the bottom panel of the console.

Navigate to Control Panel > All Control Panel Items > Network and Sharing Center on your laptop.

1. Click **Change adapter settings** in the left-side panel.
2. Right-click **Local Area Connections**.
3. Select **Properties** from the menu.
4. Select to highlight **Internet Protocol version 4 (IPv4)** on the list in the pop-up.
5. Click **Properties**.
6. Set the **IP address**. When you first boot up, the console will acquire an IP from the network or from the PC that it is directly connected to.
7. Click **OK**.



NOTE: The web connection is established on port 3000. For the IP address of the web browser you must type -<http://xxx.xxx.xxx.xxx:3000>.

Your laptop is now set up to communicate directly with your MagLink LX4 console. Enter the IP address into your browser to connect.

Refer to the opposite side of this Quick Start for instructions on how to download the manuals and log in to the console as an Administrator.

Download the Manuals

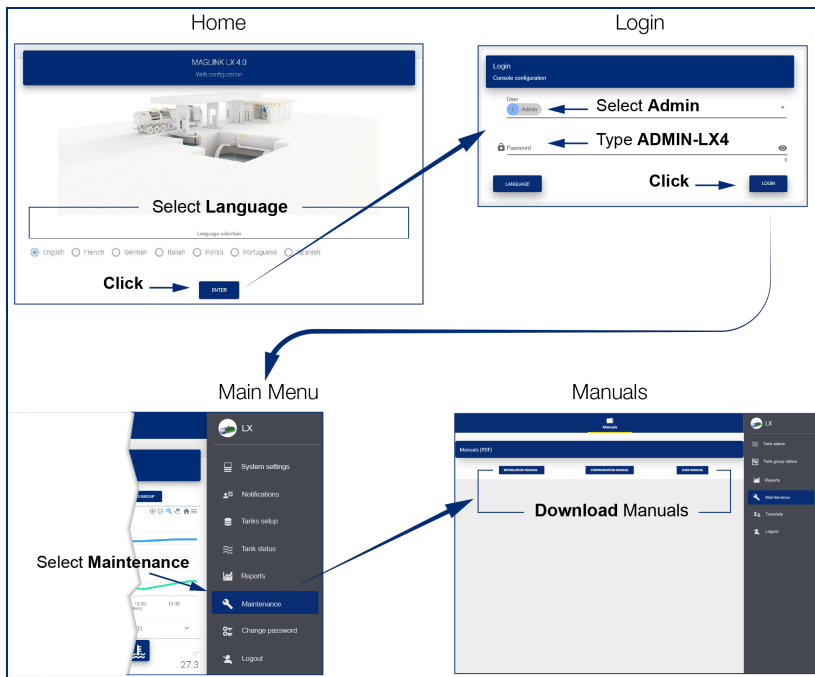

When you successfully connect to the console you will see the home screen.

- Under **Language selection**, select the radio button adjacent to the language that will be used for the configuration.
- Push the **Enter** button. The Login page will come into view.
- Select the **Admin** user type from the drop-down.
- Enter the Admin user initial Password: **ADMIN-LX4** (make sure it is all typed in uppercase).
- Push the **LOGIN** button to log in to the console with the selected *Admin* user type.

The Main Menu can be seen at the right of the screen.

- Click **Maintenance** in the *Main Menu*. The **Manuals** download screen will come into view.
- Select each of the **Manual** buttons, one at a time, to download the three manuals.
 - **Installation Manual:** This gives you all of the necessary information needed to install your LX4 console.
 - **Configuration Manual:** This gives you instructions on how to set up and customize your LX4 console to your site's specific needs.
 - **User Manual:** This shows how to operate the LX4 console through the touchscreen User Interface.

You can now refer to the Configuration Manual to complete the configuration of your LX4 console.

It is recommended that the administrator change the password as soon as possible to prevent access by personnel that are not approved (refer to the **Change Password** section for instructions).