

THIS DRAWING IS NOT TO BE SCALED. FOR ADDITIONAL INFORMATION. PLEASE CONTACT OUR ENGINEERING DEPT.

REVISIONS					
LTR	ECN #	DESCRIPTION	DRAWN	APPROVED	DATE
-	-	-	-	-	-

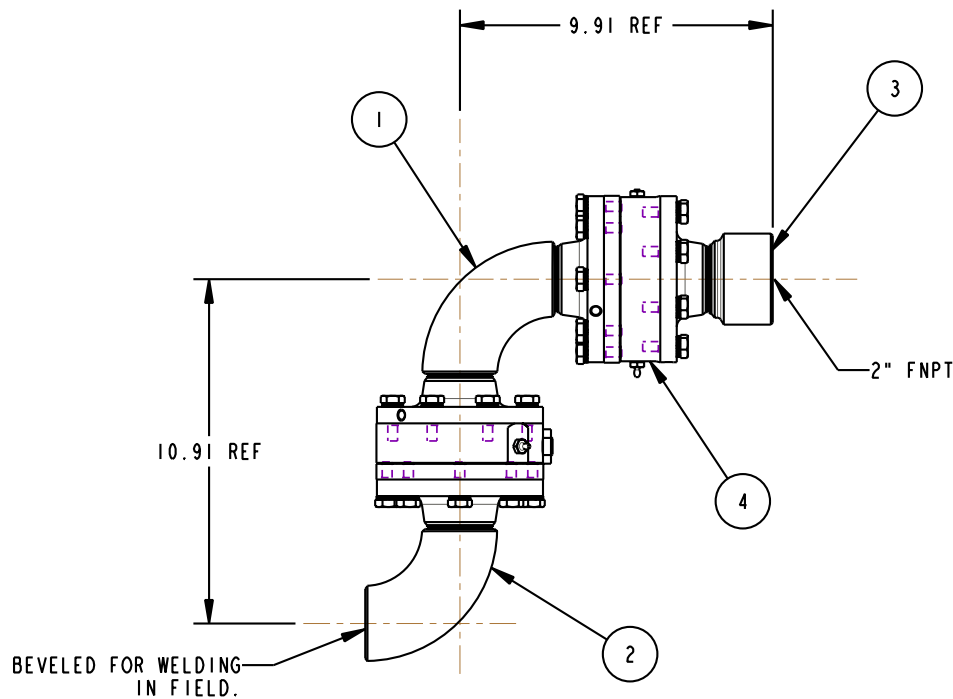
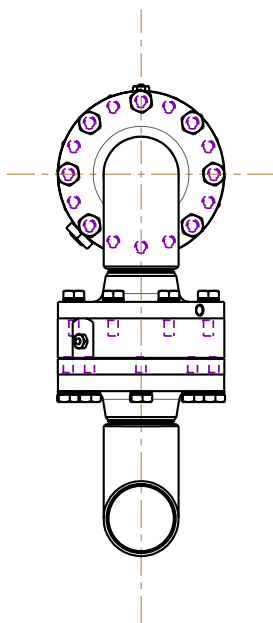
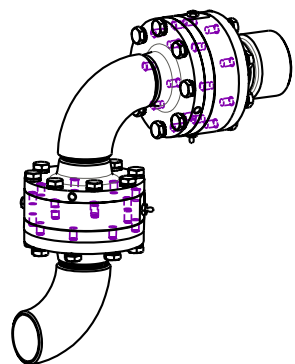

ITEM	QTY	UM	PART NUMBER	DESCRIPTION
4	2	EA	C21226	MODULE, SWIVEL, CST, DSF, 'SINGLE', 2"
3	1	EA	C20733	ASM, SF x WC, CST, DSF, 2"
2	1	EA	C20735	ASM, SF x LRE, CST, DSF, 2"
1	1	EA	C20730	ASM, SF x LRE x SF, CST, DSF, 2"

**CONFIDENTIAL** THIS DOCUMENT CONTAINS INFORMATION WHICH IS PROPRIETARY TO OPW, AND SHOULD BE PROTECTED ACCORDINGLY.

UNLESS OTHERWISE SPECIFIED  
 TOLERANCES ON DIMENSIONS  
 3 DECIMALS +/- 0.005  
 2 DECIMALS +/- 0.015  
 1 DECIMAL +/- 0.030  
 ANGLES +/- 1/2 DEG  
 MACHINED SURFACES 125 RMS MAX

SIGNATURES: DEH  
 MO-DA-YR: 01/07/2009  
 CHECKED: -  
 MATERIAL: CST

DESCRIPTION: 2" DSF SWIVEL, SINGLE, CST, WELD X 2" FNPT  
 REV: -  
 SIZE: C  
 PART NUMBER: 8250W0-0202  
 SCALE: 0.250 SHEET 1 OF 1

OPW Engineered Systems  
 A DOVER Resources Company  
 Lebanon, Ohio 45036 USA  
 3D GENERATED DRAWING