

A

B

C

D

THIS DRAWING IS NOT TO BE SCALED. FOR ADDITIONAL INFORMATION, PLEASE CONTACT OUR ENGINEERING DEPT.

REVISIONS					
LTR	ECN #	DESCRIPTION	DRAWN	APPROVED	DATE
REL	41360	INITIAL RELEASE	SCK	NAC	10/13/03

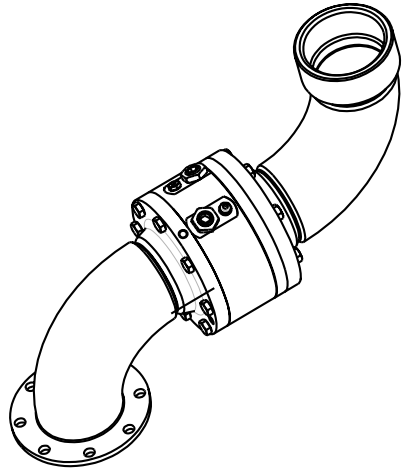

SCALE 0.200

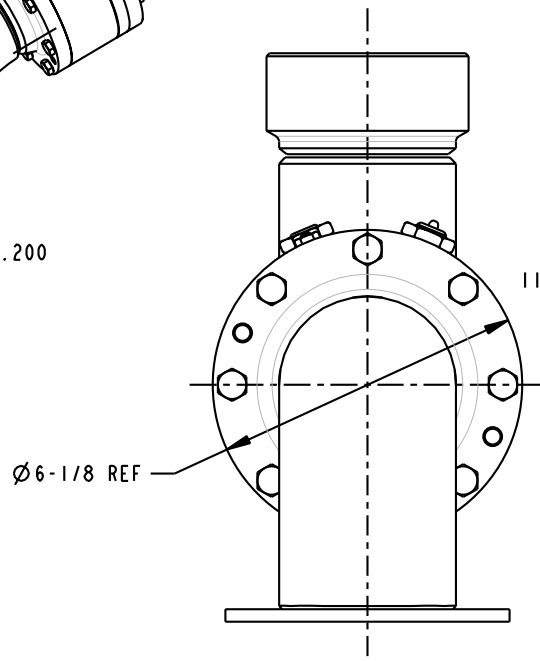

Ø6-1/8 REF

11-1/4 REF

4-11/16 REF

TTMA FLANGE

3" - 8 FNPT

6-25/32 REF

14-27/32 REF

- NOTES:
- AIR TEST @ 5 psi & 70 psi, OR HYDROSTATIC TEST PER CUSTOMER SPECIFICATION.
 - MAXIMUM PRESSURE 500 psi.

CONFIDENTIAL THIS DOCUMENT CONTAINS INFORMATION WHICH IS PROPRIETARY TO OPW, AND SHOULD BE PROTECTED ACCORDINGLY.			DESCRIPTION: SWIVEL, 3" DSF STYLE 40FTO		
UNLESS OTHERWISE SPECIFIED TOLERANCES ON DIMENSIONS		SIGNATURES		MO-DA-YR	
3 DECIMALS +/- 0.005		DRAWN: SCK		09/26/03	
2 DECIMALS +/- 0.015		CHECKED: NAC		10/13/03	
1 DECIMAL +/- 0.030		MATERIAL:		WEIGHT: 37 lbs.	
ANGLES +/- 1/2 DEG				REV: REL	
MACHINED SURFACES 125 RMS MAX				SIZE: C	
			PART NUMBER: 08X40FTO-03XX		Engineered Systems A Resources Company Lebanon, Ohio 45036 USA
			SCALE: 0.400		SHEET 1 OF 1
3D GENERATED DRAWING					

A

B

C

D