

MATERIAL:
ALUMINUM (4")

OPW Engineered Systems

STYLE 44FT SWIVEL JOINT-CAST

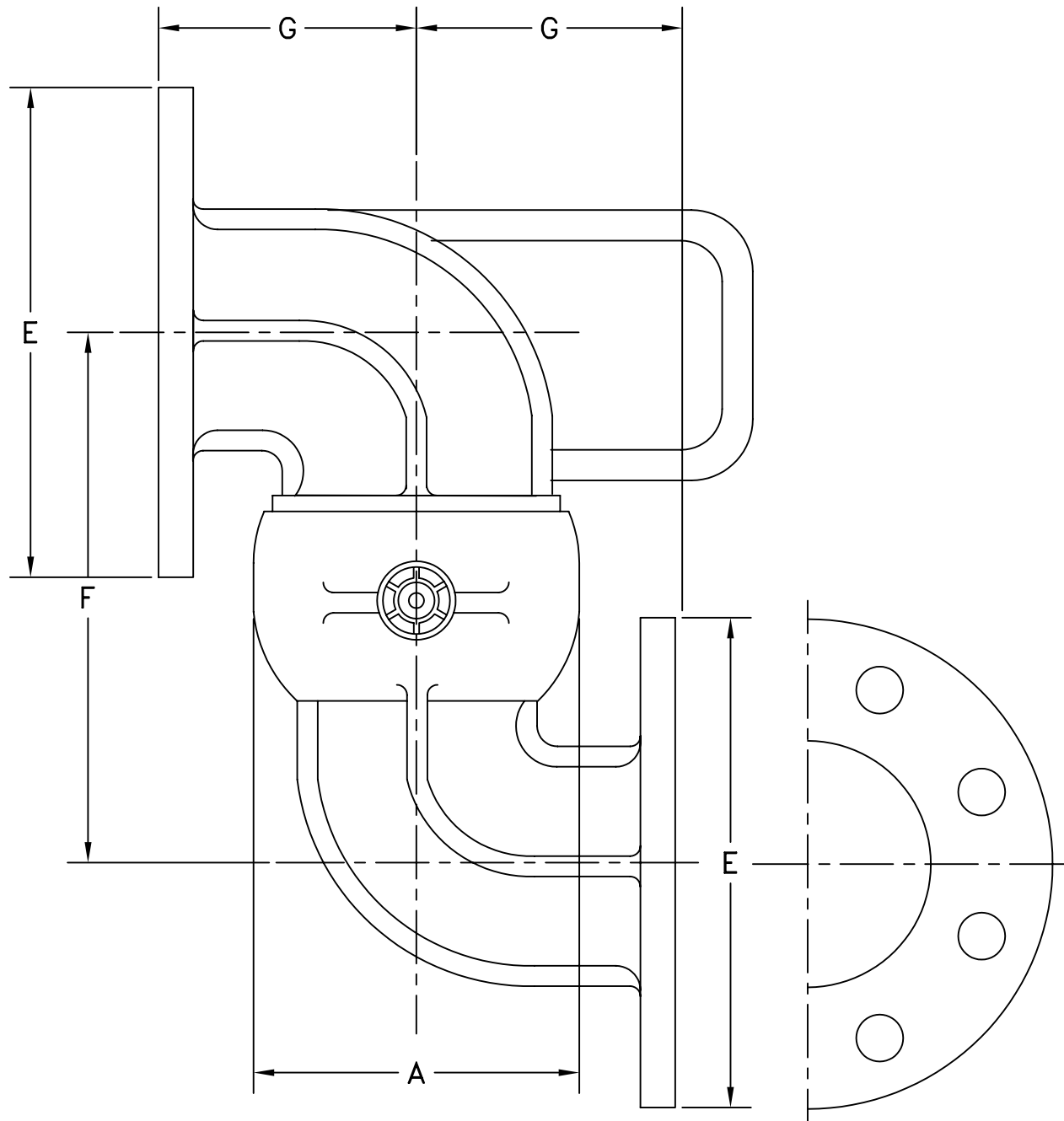

SIZE	4"
A	6-1/16"
E	6-5/8"
F	9-1/4"
G	5-7/8"
TTMA ϕ BOLT CIRCLE	5-7/8"
TTMA NO. BOLTS - ϕ	(8) 7/16"