

MATERIAL:
ALUMINUM (3" 4")

OPW Engineered Systems

STYLE 40FT SWIVEL JOINT-CAST

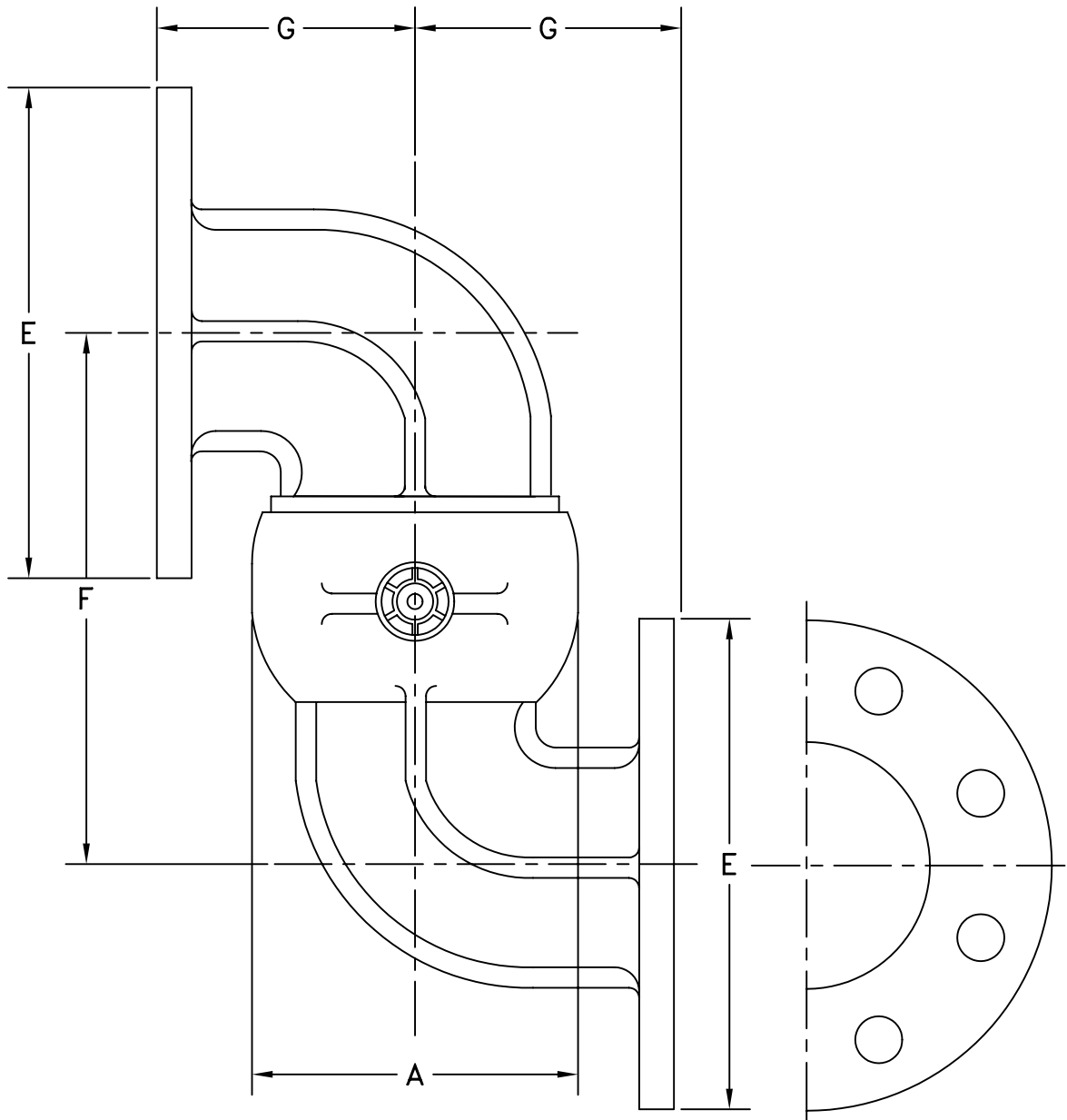

SIZE	3"	4"
A	4-7/8"	6-1/16"
E	5-5/8"	6-5/8"
F	7-5/8"	9-1/4"
G	3-9/16"	5-7/8"
TTMA ϕ BOLT CIRCLE	4-7/8"	5-7/8"
TTMA NO. BOLTS - ϕ	(8) 7/16"	(8) 7/16"