

MATERIALS OF CONSTRUCTION	CARBON STEEL
SWIVEL JOINT SEALS	PTFE ENCAPSULATED VITON
PRODUCT	ASPHALT
ESTIMATED WEIGHT	380 LBS
MOMENT LOAD AT SPRING	6680 IN-LBS
MOMENT LOAD AT INLET	21,400 IN-LBS
TEST PRESSURE	90 PSI
DESIGNED FOR PRODUCT RETENTION	NO
WEIGHT BY OTHERS	INSULATION AT 2.5 LBS/FT

2	1	EA	790B-0030	EZ ADJUST TORSION SPRING BALANCE
1	1	EA	8476FW	3" SWIVEL ASSY, ENDURA DSF, CST
ITEM	QTY	UM	PART NUMBER	DESCRIPTION

THIS DRAWING IS NOT TO BE SCALED. FOR ADDITIONAL INFORMATION, PLEASE CONTACT OUR ENGINEERING DEPT.

REVISIONS					
LTR	ECN #	DESCRIPTION	DRAWN	APPROVED	DATE
-	-	-	-	-	-

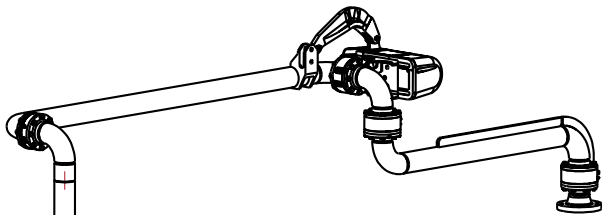
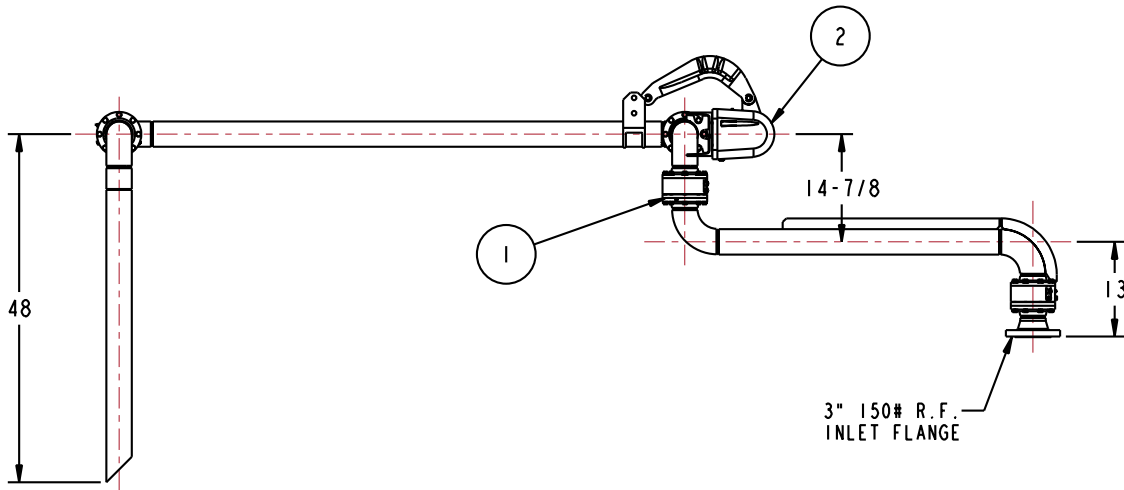
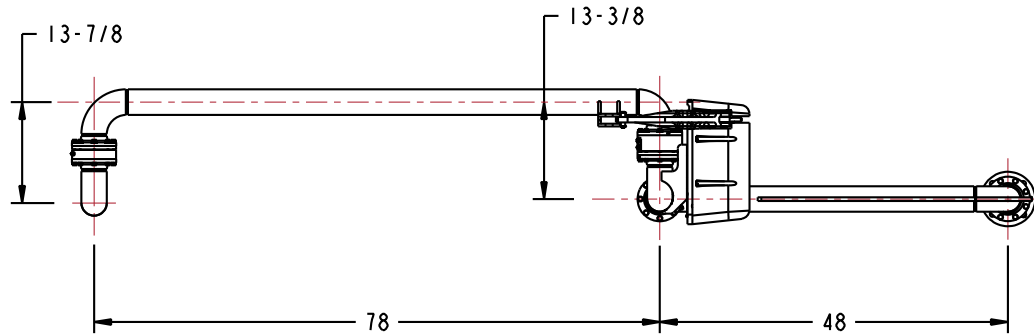

3" 150# R.F.
INLET FLANGE

CONFIDENTIAL THIS DOCUMENT CONTAINS INFORMATION WHICH IS PROPRIETARY TO OPW, AND SHOULD BE PROTECTED ACCORDINGLY.

DESCRIPTION:

3" LOADING ARM

SIGNATURES		MO-DA-YR
DRAWN: BJB		4/14/09
CHECKED:		
MATERIAL: CST	WEIGHT:	

REV: -
SIZE: D

PART NUMBER:

EGT32F-H289

SCALE: 0.080

SHEET 1 OF 4

OPW **Engineered Systems**
A **ROBERT** Resources Company
Lebanon, Ohio 45036 USA
3D GENERATED DRAWING