

A B C D E

MATERIALS OF CONSTRUCTION	STAINLESS STEEL
SWIVEL JOINT SEALS	PFA ENCAPSULATED SILICONE
PRODUCTS	(2) ARMS WITH MPEG-100/1200/2000 (2) ARMS WITH AEO-2/AEO-9 (2) ARMS WITH PEG-400
1 FLANGE GASKETS	GARLOCK GYLON 3500
WORKING PRESSURE	100 psi
PRODUCT RETENTION	YES
RADIOGRAPHIC INSPECTION	YES, 5%
MOMENT AT SPRING	11,600 inlbs
MOMENT AT INLET	SAME
DESIGNED FOR ADDITIONAL WEIGHT	YES, 20 lbs MAX

THIS DRAWING IS NOT TO BE SCALED. FOR ADDITIONAL INFORMATION, PLEASE CONTACT OUR ENGINEERING DEPT.

REVISIONS					
LTR	ECN #	DESCRIPTION	DRAWN	APPROVED	DATE
-	-	-	-	-	-

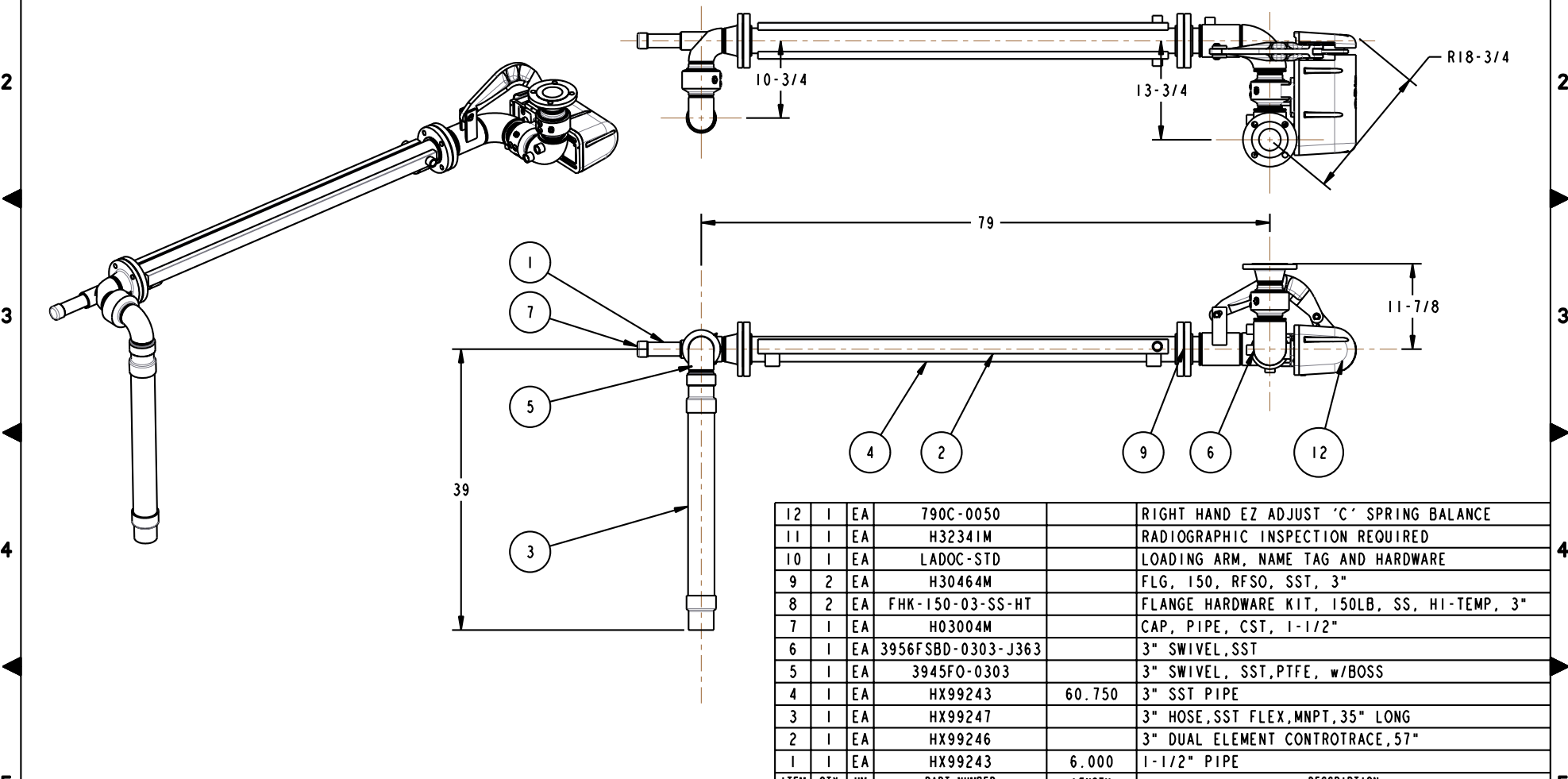

ITEM	QTY	UM	PART NUMBER	LENGTH	DESCRIPTION
12	1	EA	790C-0050		RIGHT HAND EZ ADJUST 'C' SPRING BALANCE
11	1	EA	H32341M		RADIOGRAPHIC INSPECTION REQUIRED
10	1	EA	LADOC-STD		LOADING ARM, NAME TAG AND HARDWARE
9	2	EA	H30464M		FLG, 150, RFSO, SST, 3"
8	2	EA	FHK-150-03-SS-HT		FLANGE HARDWARE KIT, 150LB, SS, HI-TEMP, 3"
7	1	EA	H03004M		CAP, PIPE, CST, 1-1/2"
6	1	EA	3956FSBD-0303-J363		3" SWIVEL, SST
5	1	EA	3945FO-0303		3" SWIVEL, SST, PTFE, w/BOSS
4	1	EA	HX99243	60.750	3" SST PIPE
3	1	EA	HX99247		3" HOSE, SST FLEX, MNPT, 35" LONG
2	1	EA	HX99246		3" DUAL ELEMENT CONTRORACE, 57"
1	1	EA	HX99243	6.000	1-1/2" PIPE

**CONFIDENTIAL** THIS DOCUMENT CONTAINS INFORMATION WHICH IS PROPRIETARY TO OPW, AND SHOULD BE PROTECTED ACCORDINGLY.

DESCRIPTION: 3" TOP LOADING ARM, SST, PTFE

SIGNATURES	MO-DA-YR	REV:	PART NUMBER:
DRAWN: SCK	11/18/10	-	J33F-J362
CHECKED:		SIZE:	D
MATERIAL: SST	WEIGHT:		

SCALE: 0.100 SHEET 1 OF 2 3D GENERATED DRAWING

**OPW Engineered Systems**  
A BOSTED Resources Company  
Lebanon, Ohio 45036 USA

A B C D E