

THIS DRAWING IS NOT TO BE SCALED. FOR ADDITIONAL INFORMATION, PLEASE CONTACT OUR ENGINEERING DEPT.

MATERIALS OF CONSTRUCTION	CARBON STEEL
SWIVEL JOINT SEALS	VITON GFLT
SWIVEL JOINT LUBE	TOMPAC BEARING GEL
PRODUCT	RESIN
ESTIMATED WEIGHT	1,350 LBS
MOMENT LOAD AT CYLINDER# 1	31,000 IN-LBS
MOMENT LOAD AT INLET	N/A
FLANGE GASKETS	N/A
TEST PRESSURE	90 PSI
PRODUCT RETENTION	NO
WEIGHT BY OTHERS	N/A
STEAM SUPPLY & RETURN HOSES	N/A
CYLINDER# 1 VERT TRAVEL	-45° TO +22°
PIPING	SCH 40 ASTM A53 GR A
FITTINGS	ASTM A105
CASTINGS	ASTM A216 WCB
FLANGE GASKET	KLINGER SIL C5400
HARDWARE(NUTS)	ASTM A194 GR 2H
HARDWARE(BOLTS)	ASTM A193 A7
TAG NO.	A4002

9	1	EA	7142LCP-G971	VAPOR PLATE, CST
8	1	EA	N/A	PNEU CYLINDER CONTROL BOX
7	1	EA	HX96858	PNEU CYLINDER
6	1	EA	HX96849	BUTTERFLY VALVE, XOMOX #801-267-TT-ST2-L
5	1	EA	HX96848	BALL VALVE, CST, 4", VELAN #F00402SSEA
4	1	EA	8476FW-G969	3" SWIVEL ASSY, ENDURA DSF, CST
3	1	EA	8440FW-G972	3" SWIVEL ASSY, ENDURA DSF, CST
2	1	EA	8440FW-G970	3" SWIVEL ASSY, ENDURA DSF, CST
1	1	EA	8430FW-G968	3" SWIVEL ASSY, ENDURA DSF, CST
ITEM	QTY	UM	PART NUMBER	DESCRIPTION

- H30133M 8 BOLT
- H06454M 8 NUT
- H30314M 8 WASHER
- HX96753 8 BOLT
- H09005M 20 BOLT
- H30314M 32 BOLT
- H04740M 60 NUT
- H02507M 60 WASHER
- H04190M 8 GASKET
- H02209PA 1 INSTRUCTION SHEET
- H30446M 1 ALUM NAME PLATE
- H30447M 2 SST TIE BANDS

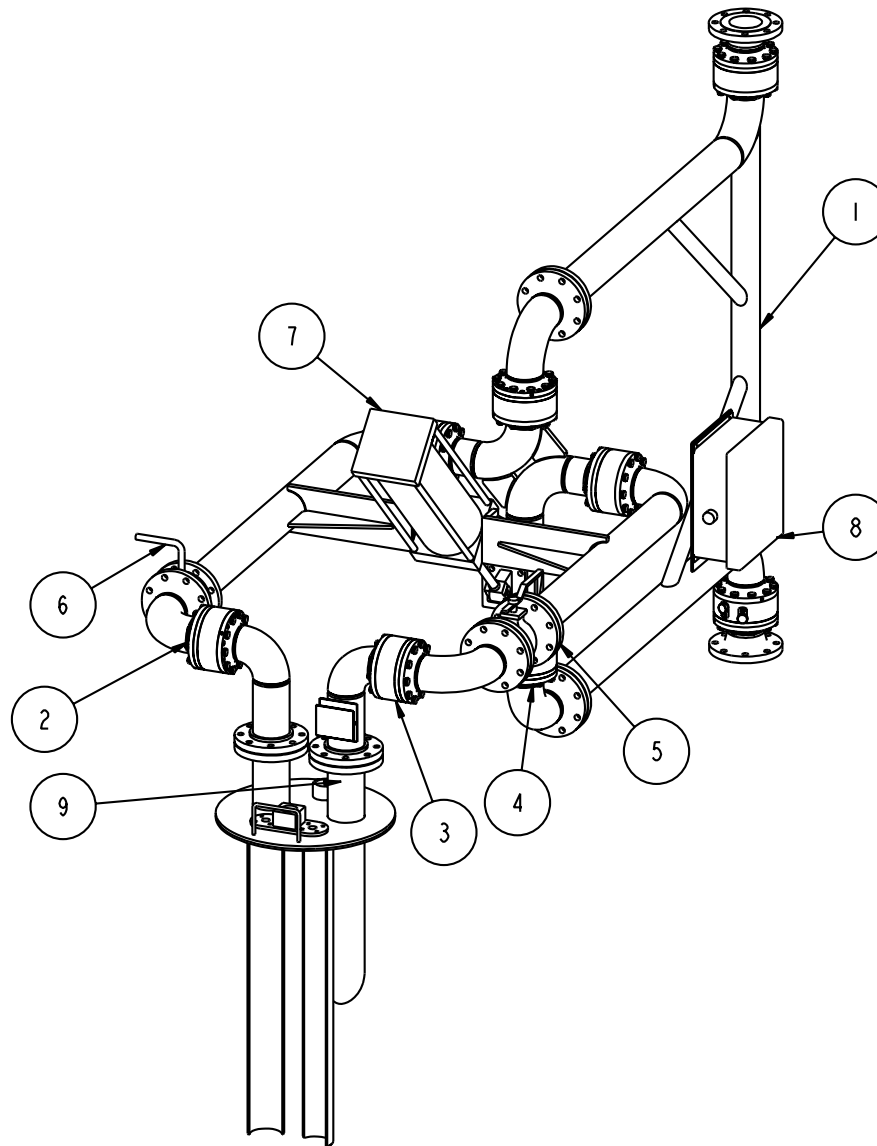

CONFIDENTIAL THIS DOCUMENT CONTAINS INFORMATION WHICH IS PROPRIETARY TO OPW, AND SHOULD BE PROTECTED ACCORDINGLY.		DESCRIPTION: 4" LOADING ARM, PNEUMATIC	
UNLESS OTHERWISE SPECIFIED TOLERANCES ON DIMENSIONS 3 DECIMALS +/- 0.005 2 DECIMALS +/- 0.015 1 DECIMAL +/- 0.030 ANGLES +/- 1/2 DEG MACHINED SURFACES 125 RMS MAX	SIGNATURES DRAWN: JLP CHECKED: MATERIAL:	MO-DA-YR 10/29/08	REV: - PART NUMBER: EB33F-G967 SCALE: 0.090
		SIZE: D	SHEET 1 OF 9
		Engineered Systems A Resources Company Lebanon, Ohio 45036 USA 3D GENERATED DRAWING	