

LIGHTWEIGHT | LOW COST

GAIN INDEPENDENCE FROM STEEL COVERS WITH THE NEW OPW MATADOR COMPOSITE MANHOLE COVER.

Value Tough Enough to Stop a Raging Bull.

Say goodbye to heavy steel covers! Say hello to the NEW Matador composite cover by OPW. The Matador cover features OPW's next-generation composite technology – making it the preferred low cost and lightest manhole cover on the market today.

Help to make sump accessibility safer and easier by specifying the NEW Matador by OPW. Not only will the Matador lightweight composite cover help to put an end to the risk of back, foot and hand injuries, it will also deliver long-lasting performance.

Features Include:

- ◆ Legendary OPW quality and reliability
- ◆ Lightweight design makes sump access safer and easier
- ◆ Slip-resistant textured surface helps to prevent injuries
- ◆ Water and UV resistant
- ◆ Corrosion resistant
- ◆ Painted, steel frame
- ◆ Polyethylene skirt
- ◆ Recessed stainless steel lift handle

MATADOR

COMPOSITE COVER

Gain independence from heavy steel covers with this all-new composite cover. OPW engineered the Matador with next generation composite technology to make it the lightest cover in the industry, and priced it to compete with any cover on the market.

Features Include:

- ◆ Lightweight design helps to reduce risk of back, foot and hand injuries
- ◆ Slip-resistant tread pattern
- ◆ Water resistant
- ◆ Easy removal and replacement
- ◆ Stainless steel recessed handle
- ◆ Exceptional deflection performance
- ◆ Long-life performance – comparable to heavier competitor models in cycle tests
- ◆ Special structural fiberglass reinforcement matrix
- ◆ Two mounting options
- ◆ Roto-Lock Option – for providing a secure locking mechanism without the need to locate threaded bolt holes on the mounting ring. The Roto-Lock offers quick and easy access while maintaining a secure sump application.
- ◆ Painted steel frame
- ◆ Polyethylene skirt with flair
- ◆ H20 Rating – Exceeds Highway Specification – 20 (H20) Rating
- ◆ Flared skirt allows equivalent water percolation to 39" and 44" covers

Dimensions

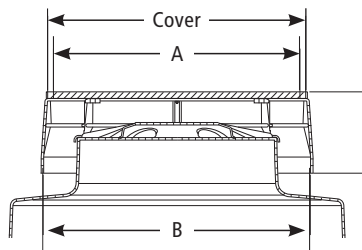
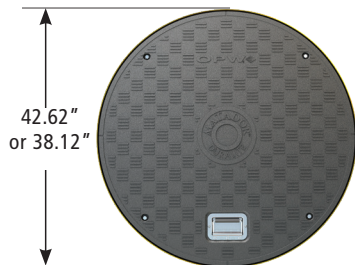

Cover	A (Ring I.D.)		B (Skirt I.D.)		Assembly Weight (Plain)		Assembly Weight (Cam-Lock)	
37.50	35.50 in	90.17 cm	38.62 in	98.09 cm	83.00 lbs	37.65 kg	86.00 lbs	39.00 kg
42.00	40.00 in	101.60 cm	43.50 in	110.49 cm	105.00 lbs	47.63 kg	109.00 lbs	49.44 kg

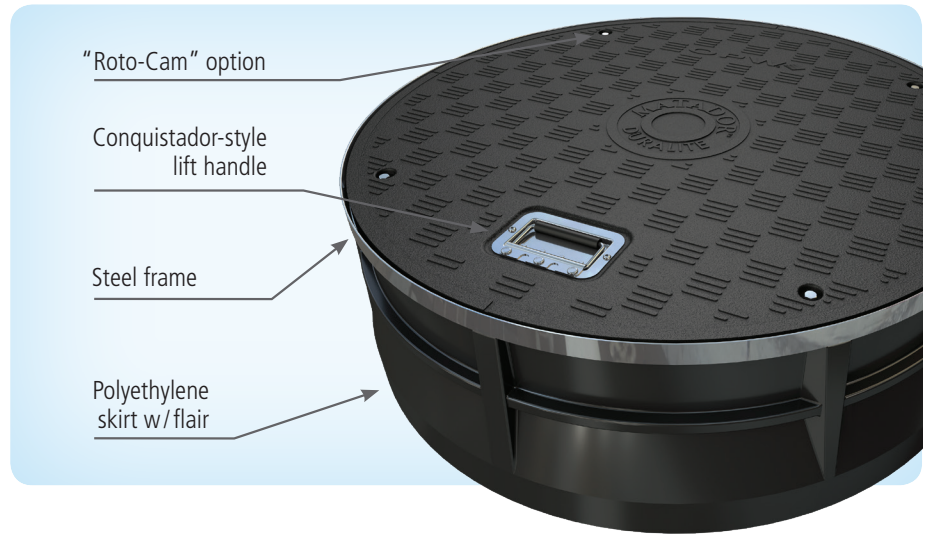

Ordering Specifications

Product #	Description	Covers Only	Cover Only Weight	
			lb.	kg
37MAT-PL12	37" Plain Matador Composite Cover, Includes Ring and Skirt	212529	63.00	28.58
37MAT-CM12	37" Cam-Lock Matador Composite Cover, Includes Ring and Skirt	212168	66.00	29.94
42MAT-PL12	42" Plain Matador Composite Cover, Includes Ring and Skirt	212518	83.00	37.65
42MAT-CM12	42" Cam-Lock Matador Composite Cover, Includes Ring and Skirt	212164	87.00	39.46
203666	Replacement Handle Kit	Equivalent to Conquistador replacement numbers		
205749	Replacement Handle Only			
203174	Replacement Handle Screw Only			
1CL-KIT	Replacement Cam Kit			

Materials

Cover: Fiberglass

Ring: Painted Steel

Skirt: Polyethylene

Recessed Handle: Stainless steel

Roto Locks: Ductile iron

Performance Chart

