

66CLP RECONNECTABLE BALANCE BREAKAWAY

1. Hose could be caught on vehicle resulting in direct pull on retractor cable or pump, bypassing breakaway.
2. Pump dispenser cabinet must be securely anchored with bolts not less than 1/2 inch in diameter, located on opposite sides of the base not less than 13 inches apart.

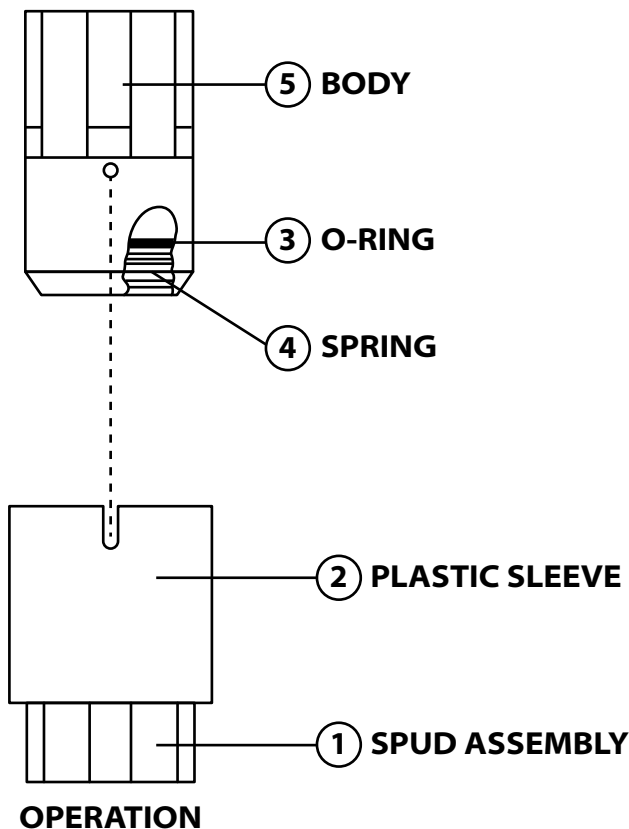

If Separation Occurs on Model 66CLP:

1. Shut off dispenser and relieve line pressure.
2. Inspect spud assembly (item 1) for physical damage, such as, cracks to plastic sleeve (item 2), abrasions, or cuts. If damaged, replace breakaway.
3. Inspect O-ring (item 3) for damage; if damaged, replace breakaway.
4. Inspect spring (item 4) for damage; if damaged, replace breakaway.
5. Lubricate O-ring (item 3) with light oil or silicone oil.
6. Hold the body (item 5) horizontally and center the spring (item 4) in the body. Align slots of plastic sleeve (item 2) with pins in body. Push the spud assembly into the body. Once you feel the spud assembly enter the spring, continue pushing until parts latch together. Pull back on the assembly to check for secure reconnect. Repressurize the unit and check for leakage.
7. Model 66CLP is ready for use.

SITE NAME:

ADDRESS: